

Yonge – Eglinton PART

Meeting #6

November 5, 2015



Agenda

5:00 p.m. to 7:00 p.m.

1.	Welcome
2.	Discussion of Feedback from Public Meetings
3.	Presentation and Discussion of Revised Model
4.	PART Decision
5.	Next Steps
6.	Adjournment

Program Area Review Team's Proposed Scenario Presented at Public Meetings

2016

- Shared area boundary change between Eglinton Jr. PS/Hodgson Sr. PS and Northlea E & MS
- Forest Hill Jr. and Sr. PS Extended French program's Grade 4 entry cohort reduced to 1 class of 30 going forward so that program can remain at the school through to Grade 8
- Re-align intermediate boundaries for Hodgson Sr. PS, Glenview Sr. PS, and Forest Hill Jr. & Sr. PS

2017

- Grade changes at Eglinton Jr. PS/Davisville Jr. PS (English track only)/Maurice Cody Jr. PS/Oriole Park Jr. PS and Hodgson Sr. PS
- Spectrum Alternative Senior School remains a Grade 7-8 program

2020

- Assuming Davisville Jr. PS rebuild is complete; Grade 6s (English track) could stay at Davisville Jr. PS (pending space pressures at Davisville Jr. PS and Hodgson Sr. PS)
- Hodgson Sr. PS would no longer take in Grade 6 students from Davisville Jr. PS (would take in at Grade 7)

2022

- Potential boundary change between Eglinton Jr. PS and Maurice Cody Jr. PS (contingent on there being space at Maurice Cody Jr. PS and continued accommodation pressures at Eglinton Jr. PS)

Community Feedback

Shared area boundary change between Eglinton Jr. PS/Hodgson Sr. PS and Northlea E & MS in 2016

- No comments submitted

Forest Hill Jr. and Sr. PS Extended French program's Grade 4 entry cohort reduced to 1 class of 30 going forward so that program can remain at the school through to Grade 8 (2016)

- Where would additional students go?
- Why can't Forest Hill Jr. & Sr. PS students move to Hodgson Sr. PS for Extended French (6-8)?
- Will existing students be required to move next year?
- Will siblings be given priority?

Re-align intermediate boundaries for Hodgson Sr. PS, Glenview Sr. PS, and Forest Hill Jr. & Sr. PS (2016)

- No comments submitted re. Hodgson Sr. PS/Glenview Sr. PS re-alignment
- Keep existing boundaries for Oriole Park Jr. PS/Forest Hill Jr. PS ("triangle" area) – walking distance and secondary school issue
- If boundary change occurs so all of Oriole Park Jr. PS students go to Hodgson Sr. PS, align secondary boundary (Northern SS/North Toronto CI vs. Forest Hill CI) with intermediate and junior boundaries so cohort does not split at Grade 9

Community Feedback

Grade changes at Eglinton Jr. PS/Davisville Jr. PS (English track only)/Maurice Cody Jr. PS/Oriole Park Jr. PS and Hodgson Sr. PS (2017)

- Davisville Jr. PS is already overcrowded and would like to move in 2016 – 16 resource-sized classrooms, prohibitive-to-repair school
- Can Oriole Park Jr. PS Grade 6 students remain at the school?
- Delaying move until 2017 allows for smoother transition
- Can move be delayed until Hodgson Sr. PS addition is built?
- Emotional/psychological support for transitioning Grade 6 students
- Walking distance to Hodgson Sr. PS is worrisome
- Lack of childcare for Grade 6 students at Hodgson Sr. PS
- How would programming improve at Hodgson Sr. PS vs. junior schools?
- Too many portables/lack of green space at Hodgson Sr. PS
- Not enough washrooms at Hodgson Sr. PS for additional students

Spectrum Alternative Senior School remains a Grade 7-8 program

- Can Spectrum become a 6-8 School?
- Can Spectrum be moved out of Davisville Jr. PS to free up classrooms?

Assuming Davisville Jr. PS rebuild is complete, Grade 6s (English track) could stay at Davisville Jr. PS (2020)

- Davisville Jr. PS Grade 6s should remain at Hodgson Sr. PS (with other feeder school cohorts)

Community Feedback

Potential boundary change between Eglinton Jr. PS and Maurice Cody Jr. PS in 2022

- No comments submitted

Other comments

- Has redevelopment of Eglinton Jr. PS site been considered?
- Have solutions involving schools in adjacent wards been considered?
- Uncertainty over impact of residential development
- Relocate child care from Maurice Cody Jr. PS and Oriole Park Jr. PS to free up classrooms at the schools
- Community consultation process perceived as being shorter than 2008/09 PARC process

Revised Model

2016

- Shared area boundary change between Eglinton Jr. PS/Hodgson Sr. PS and Northlea E & MS
- Forest Hill Jr. and Sr. PS Extended French program's Grade 4 entry cohort reduced to 1 class of 30 going forward so that program can remain at the school through to Grade 8
- Re-align intermediate boundaries for Hodgson Sr. PS and Glenview Sr. PS
- Portion of Oriole Park Jr. PS' junior attendance area that feeds to Forest Hill Jr. & Sr. PS becomes **shared** attendance area – students in Grades 6-8 residing in "triangle" have option to attend Hodgson Sr. PS **or** Forest Hill Jr. & Sr. PS (impacts 7/8 students only in 2016, and then 6-8 students in 2017 and beyond after grade changes occur)

2017

- Grade changes at Eglinton Jr. PS/Davisville Jr. PS (English track only)/Maurice Cody Jr. PS/Oriole Park Jr. PS and Hodgson Sr. PS
- Spectrum Alternative Senior School remains a Grade 7-8 program

2018

- Hodgson Sr. PS addition is complete (tentative)

2020

- Davisville Jr. PS replacement building is complete (tentative)
- Review accommodation options for the Davisville Jr. PS Grade 6 students

2022

- Potential boundary change between Eglinton Jr. PS and Maurice Cody Jr. PS (contingent on there being space at Maurice Cody Jr. PS and continued accommodation pressures at Eglinton Jr. PS)

Overview of Actual and Projected Enrolment – Proposed Model (Ward 11 Schools)

Davisville Jr. and Sr. PS and Spectrum Alternative School

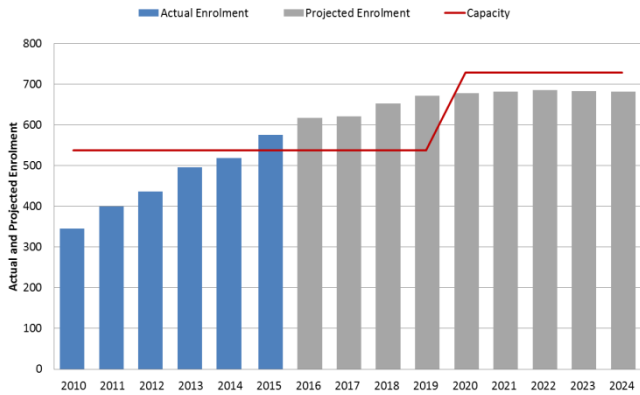

2015: 107% utilization
2024: 94% utilization

Maurice Cody Junior PS

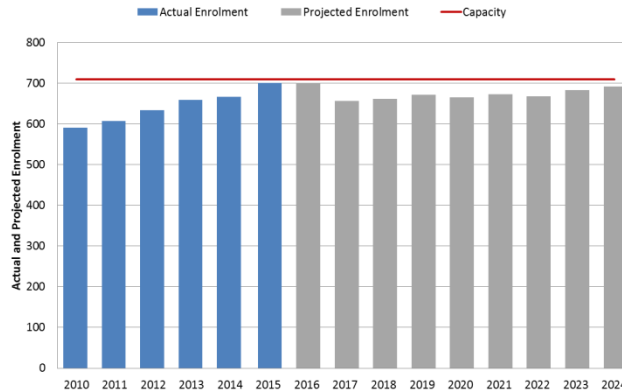

2015: 99% utilization
2024: 98% utilization

Forest Hill Junior and Senior PS

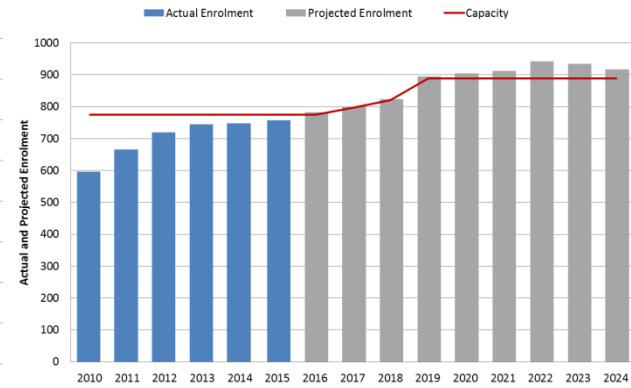

2015: 98% utilization
2024: 103% utilization*

Eglinton Junior PS

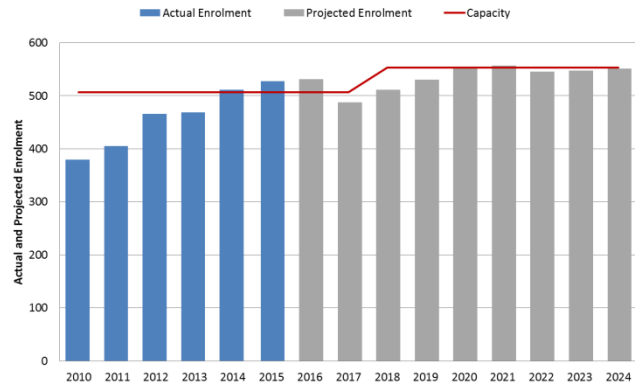

2015: 104% utilization
2024: 100% utilization

Oriole Park Junior PS

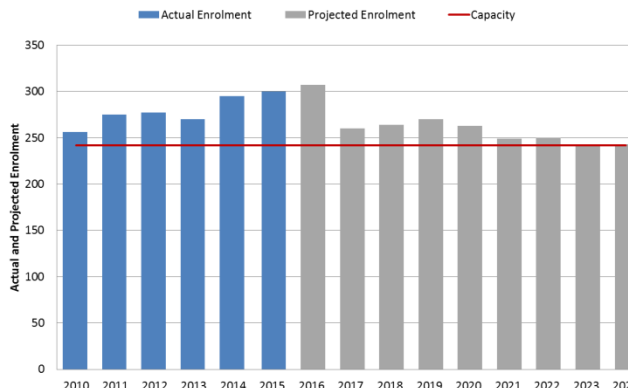

2015: 124% utilization
2024: 100% utilization

Hodgson Senior PS

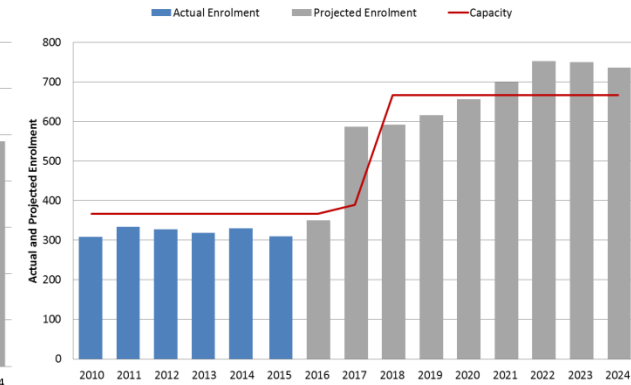

2015: 84% utilization
2024: 111% utilization*

*Additional classrooms not required beyond planned retrofits and/or addition.
Classrooms are loaded at 23 for capacity calculations.
Classrooms required based on FDK divisor of 30, primary divisor of 20, and junior/intermediate divisor of 27.

PART Decision to be Reached on the Following Items:

1. Revise shared attendance area (Eglinton Jr. PS/Hodgson Sr. PS and Northlea E & MS) so it is directed entirely to Northlea E & MS for September 2016
2. Intermediate attendance area re-alignments (Glenview Sr. PS/Hodgson Sr. PS) – Allenby Jr. PS and Eglinton Jr. PS areas for September 2016
3. Boundary change for Oriole Park Jr. PS-Forest Hill Jr. & Sr. PS “triangle” area – from Forest Hill Jr. & Sr. PS to “shared” attendance area between Forest Hill Jr. & Sr. PS/Hodgson Sr. PS for September 2016 (for Grades 7-8 only in 2016 and Grades 6-8 from 2017 onward)
4. Retain the Extended French program at Forest Hill Jr. & Sr. PS through to Grade 8 and reduce entry to 1 class for September 2016 onward
5. Grade changes from JK-6 to JK-5 at Davisville Jr. PS (English stream), Eglinton Jr. PS (English & Extended French), Maurice Cody Jr. PS, and Oriole Park Jr. PS for September 2017
6. Grade changes from 7-8 to 6-8 at Hodgson Sr. PS (English and Extended French) for September 2017
7. School name change: Hodgson Sr. PS to Hodgson MS for September 2017
8. Review accommodation options for the Davisville Jr. PS Grade 6 students upon opening of Davisville Jr. PS/Spectrum Alternative School new facility in (est.) 2020
9. Review the Maurice Cody Jr. PS/Eglinton Jr. PS boundary change in (est.) 2022

Next steps...

- Public meeting #3 on Tuesday, November 17th to share PART recommendations with community.
- Report outlining staff recommendations scheduled to be brought forth for Board approval in February 2016.
 - Prior to the Board meeting, there will be an opportunity for public to depute at the Planning & Priorities Committee, held a week prior to the regular Board meeting.
- TDSB staff continue to monitor student enrolment, demographic trends, and residential developments.
- To support long-term growth in this area, 'creative' options continue to be explored by staff (i.e., "vertical schools" and incorporating satellite spaces for TDSB classrooms or child care space in new residential developments)



Yonge-Eglinton PART – Meeting #6

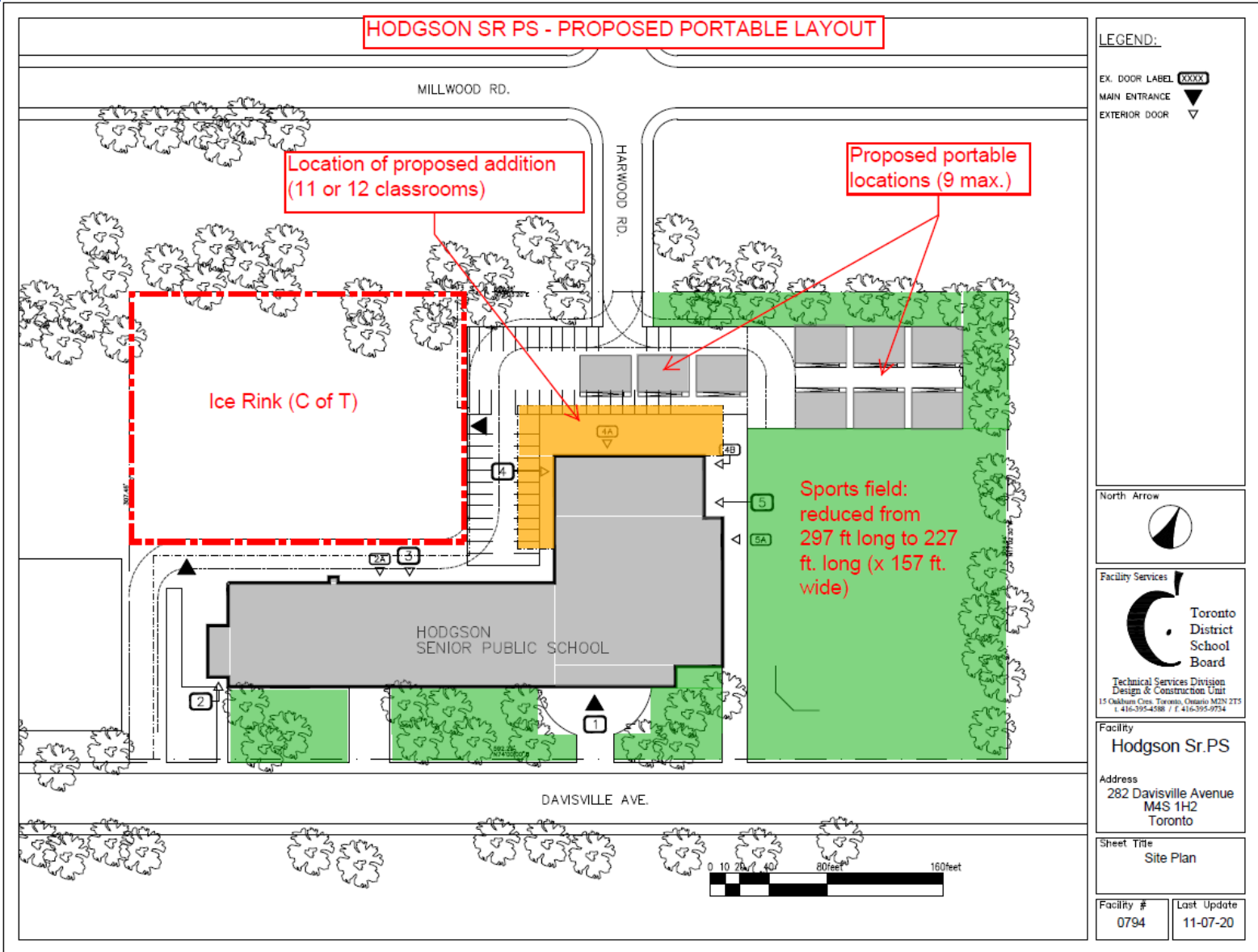

Yonge-Eglinton PART – Meeting #6

Hodgson Senior PS
Current and Long-Term
Room Uses and Capacity

Classroom requirements and uses at most constrained year (2022 onward):

Reg classrooms - 27 (23 Reg., 2 Ext. Fr.)
Specialty - 2 (Music & D+T)
Special Education - 1 (HSP)
TOTAL = 30

- Legend:**
- Kindergarten 900+ sq ft
 - Kindergarten 800-900 sq ft
 - Regular Classroom 700+ sq ft
 - Special Education Classroom
 - Specialty Classroom
 - Resource Room 400-700 sq ft
 - Seminar Room <400 sq ft
 - Child Care Exclusive Use
 - Child Care Shared Use
 - # of rooms required by year
 - Room Use

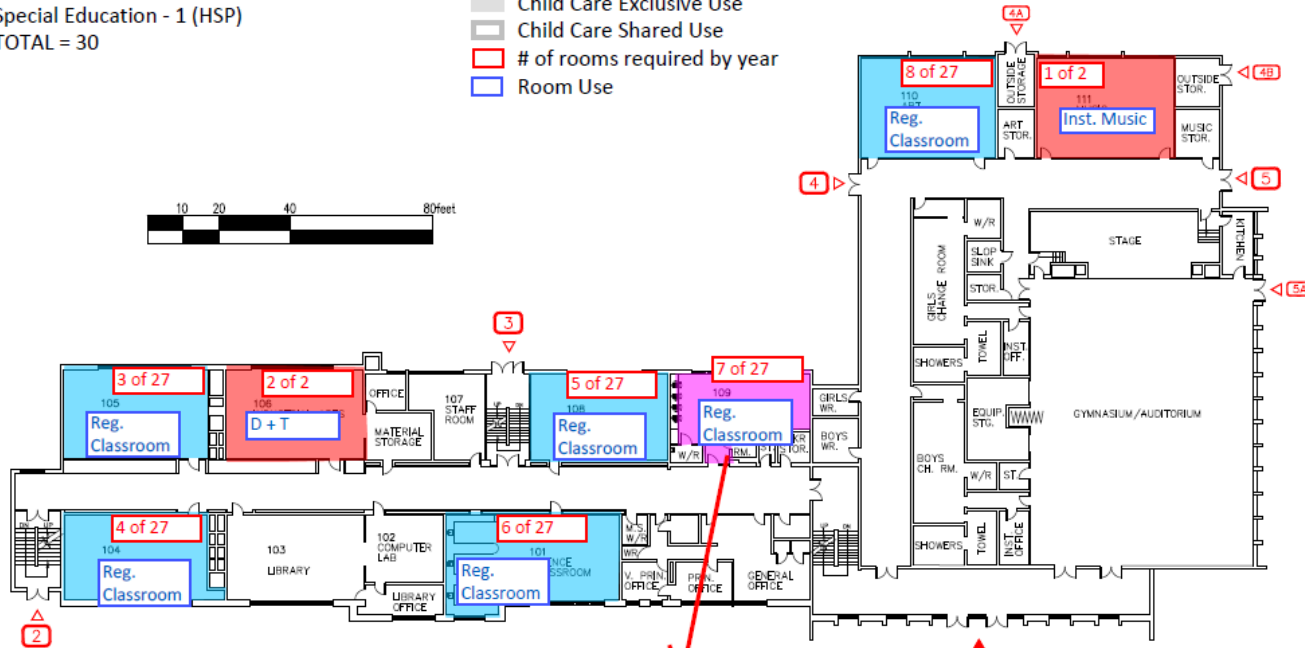

This is a resource-sized classroom previously used for LD, but will be used for regular classroom space in 2015 onward.

LEGEND:

- EX. DOOR LABEL XXXX
- MAIN ENTRANCE ▼
- EXTERIOR DOOR ▽

North Arrow

Facility Services



Technical Services Division
Design & Construction Unit
15 Oakham Cir. Toronto, Ontario M2N 2T5
T 416-395-4888 / F 416-395-9734

Facility

Hodgson Sr. PS

Address
282 Davisville Avenue
M4S 1H2
Toronto

Sheet Title

1st Floor

Facility #

0794

Last Update

13-11-21

Yonge-Eglinton PART – Meeting #6

Hodgson Senior PS
Current and Long-Term
Room Uses and Capacity

Legend:

- Kindergarten 900+ sq ft
- Kindergarten 800-900 sq ft
- Regular Classroom 700+ sq ft
- Special Education Classroom
- Specialty Classroom
- Resource Room 400-700 sq ft
- Seminar Room <400 sq ft
- Child Care Exclusive Use
- Child Care Shared Use
- # of rooms required by year
- Room Use

Classroom requirements and uses at most constrained year (2022 onward):

Reg classrooms - 27 (23 Reg., 2 Ext. Fr.)
Specialty - 2 (Music & D+T)
Special Education - 1 (HSP)
TOTAL = 30

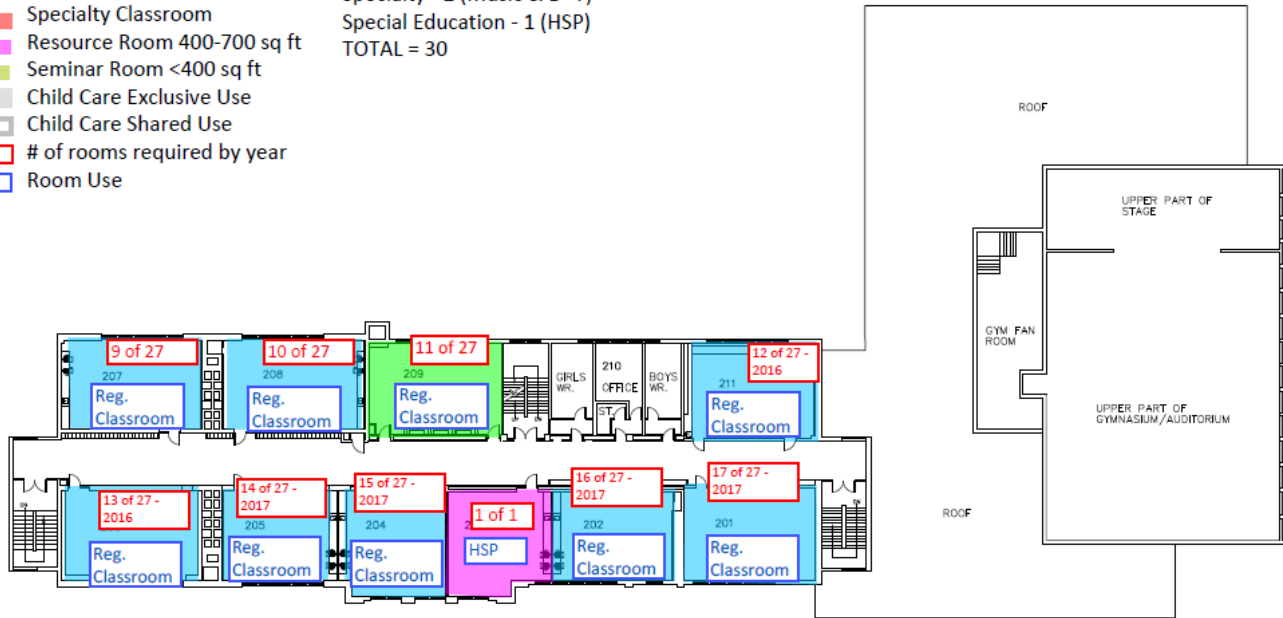

12 room addition

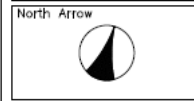

Facility Services
Toronto District School Board
Technical Services Division
Design & Construction Unit
15 Oaklum Cres, Toronto, Ontario M2N 2T5
T: 416-395-4588 / F: 416-395-9754

Facility
Hodgson Sr.PS
Address
282 Davisville Avenue
M4S 1H2
Toronto

Sheet Title
2nd Floor

Facility # 0794	Last Update 13-11-21
--------------------	-------------------------

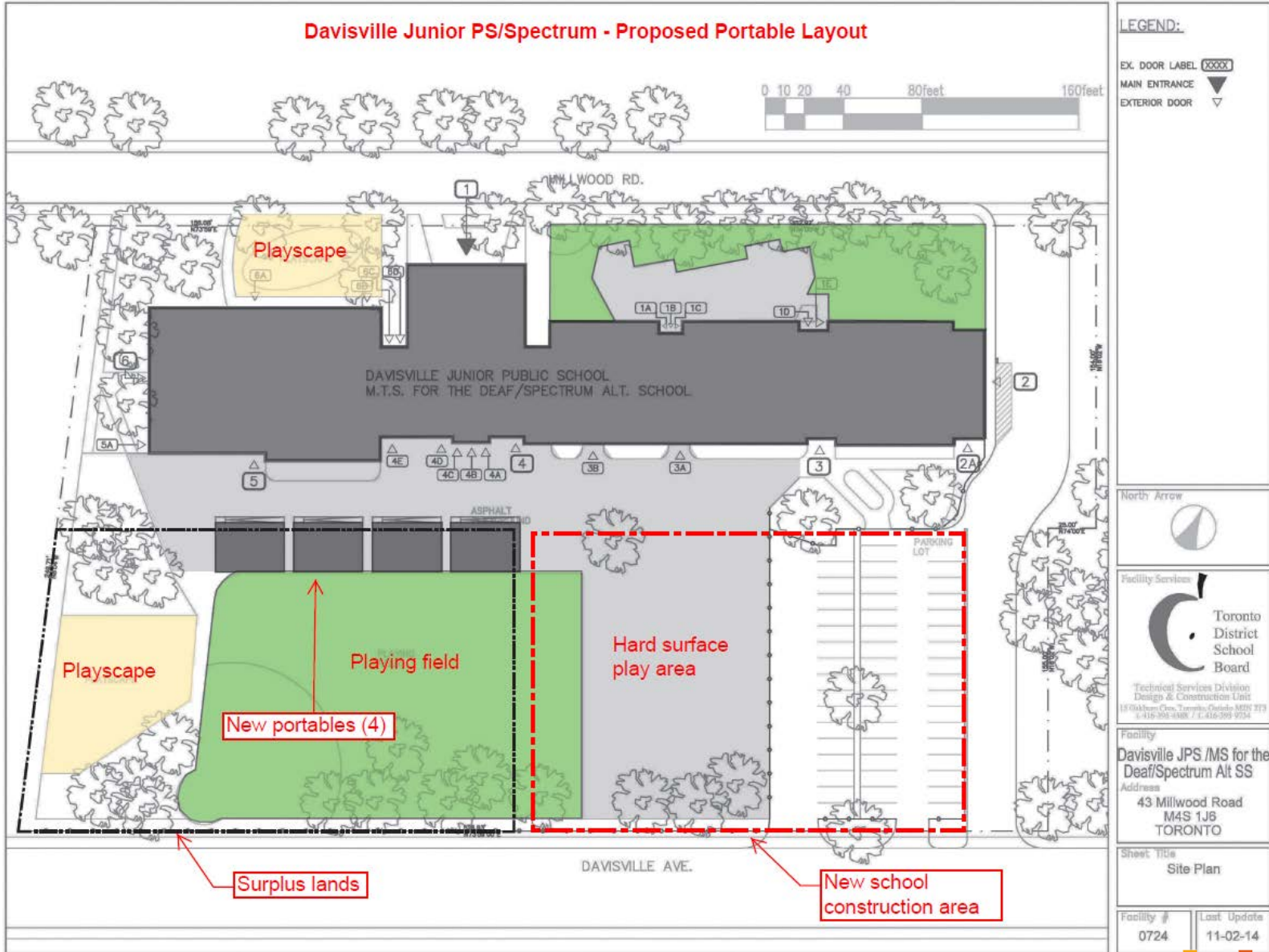

Yonge-Eglinton PART – Meeting #6

Davisville JPS /Spectrum Alt SS
Current and Long-Term Room Uses

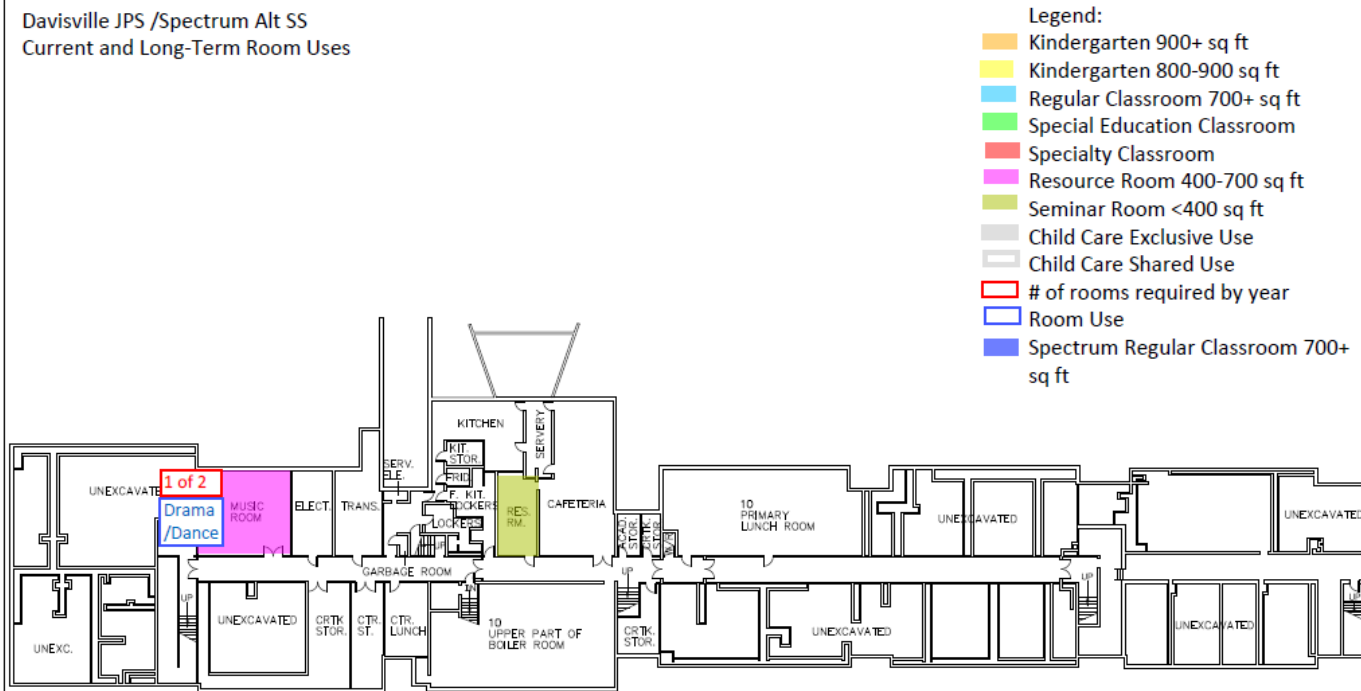

Classroom requirements and uses at most constrained year (2021 onward):

- FDK - 6 (4 reg and 2 FI)
- Reg classrooms - 21 (9 reg and 12 FI)
- Specialty - 3 (2 Davisville, 1 Spectrum)
- Additional Gyms - 1 (Rooms 305 & 306)
- Special Education - 1 (HSP)
- ESL - 2 (Primary and Junior)
- Child Care (Excl.) - 4
- Spectrum - 3
- TOTAL = 41**



Facility Services

Technical Services Division
Design & Construction Unit
15 Oakburn Cres. Toronto, Ontario M2N 2T5
416-995-4388 / 416-995-0724

Facility
Davisville JPS /MS for the Deaf/Spectrum Alt SS
Address
43 Millwood Road
M4S 1J6
TORONTO

Sheet Title
Basement

Facility # 0724	Last Update 10-08-09
--------------------	-------------------------

Yonge-Eglinton PART – Meeting #6

Davisville JPS /Spectrum Alt SS
Current and Long-Term Room Uses

- Legend:**
- Kindergarten 900+ sq ft
 - Kindergarten 800-900 sq ft
 - Regular Classroom 700+ sq ft
 - Special Education Classroom
 - Specialty Classroom
 - Resource Room 400-700 sq ft
 - Seminar Room <400 sq ft
 - Child Care Exclusive Use
 - Child Care Shared Use
 - 1 # of rooms required by year
 - JK/SK Room Use
 - JK/SK Spectrum Regular Classroom 700+ sq ft

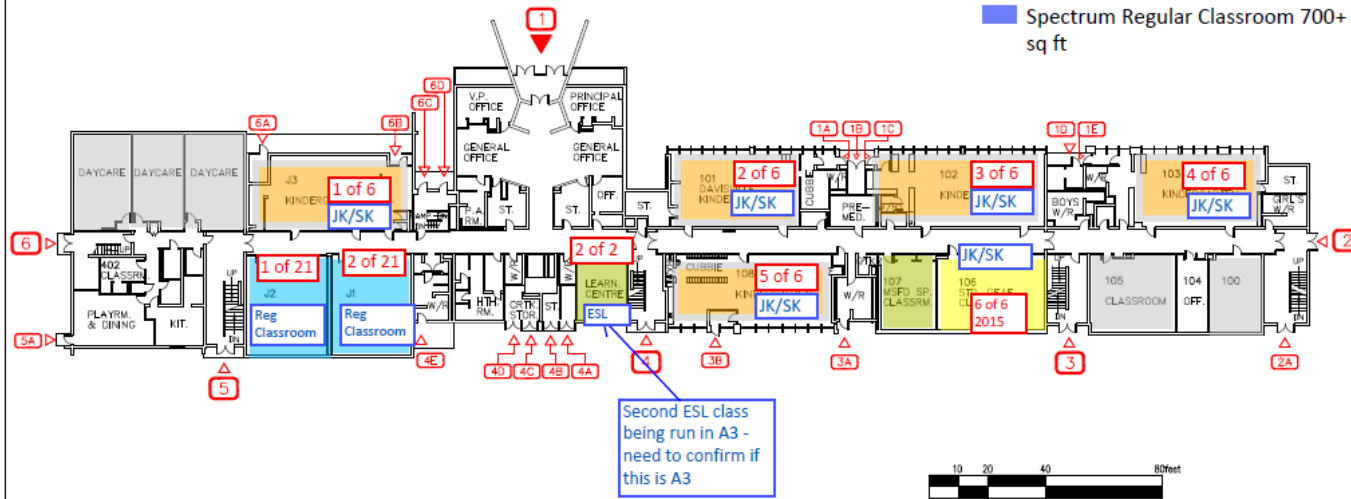

Classroom requirements and uses at most constrained year (2021 onward):

- FDK - 6 (4 reg and 2 FI)
- Reg classrooms - 21 (9 reg and 12 FI)
- Specialty - 3 (2 Davisville, 1 Spectrum)
- Additional Gyms - 1 (Rooms 305 & 306)
- Special Education - 1 (HSP)
- ESL - 2 (Primary and Junior)
- Child Care (Excl.) - 4
- Spectrum - 3
- TOTAL = 41**

LEGEND:

- EX. DOOR LABEL XXXX
- MAIN ENTRANCE
- EXTERIOR DOOR

North Arrow

Facility Services

Toronto District School Board

Technical Services Division
Design & Construction Unit
15 Oakville Cres, Toronto, Ontario M2N 2T5
T 416-395-4588 / F 416-395-9754

Facility
Davisville JPS /MS for the Deaf/Spectrum Alt SS
Address
43 Millwood Road
M4S 1J6
TORONTO

Sheet Title
1st floor

Facility # 0724	Last Update 14-08-27
--------------------	-------------------------

Yonge-Eglinton PART – Meeting #6

Davisville JPS /Spectrum Alt SS
Current and Long-Term Room Uses

- Legend:
- Kindergarten 900+ sq ft
 - Kindergarten 800-900 sq ft
 - Regular Classroom 700+ sq ft
 - Special Education Classroom
 - Specialty Classroom
 - Resource Room 400-700 sq ft
 - Seminar Room <400 sq ft
 - Child Care Exclusive Use
 - Child Care Shared Use
 - # of rooms required by year
 - Room Use
 - Spectrum Regular Classroom 700+ sq ft

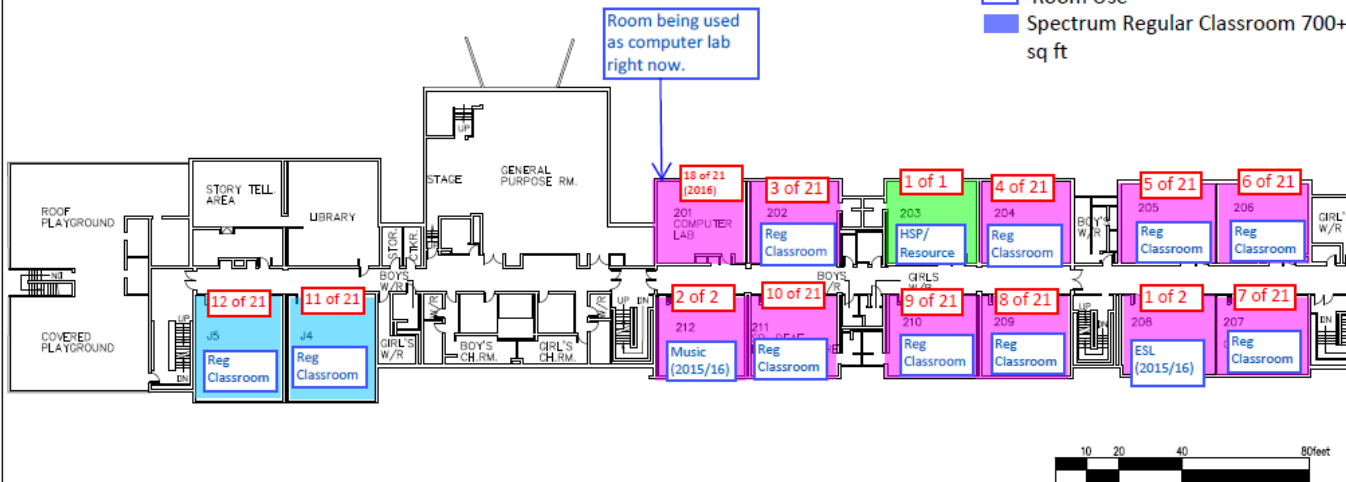

Classroom requirements and uses at most constrained year

(2021 onward):

- FDK - 6 (4 reg and 2 FI)
- Reg classrooms - 21 (9 reg and 12 FI)
- Specialty - 3 (2 Davisville, 1 Spectrum)
- Additional Gyms - 1 (Rooms 305 & 306)
- Special Education - 1 (HSP)
- ESL - 2 (Primary and Junior)
- Child Care (Excl.) - 4
- Spectrum - 3
- TOTAL = 41

North Arrow



Facility Services



Technical Services Division
Design & Construction Unit
15 Oakville Ctr. Toronto, Ontario M2N 2T5
T 416-395-4588 / F 416-395-9752

Facility

Davisville JPS /MS for the
Deaf/Spectrum Alt SS

Address
43 Millwood Road
M4S 1J6
TORONTO

Sheet Title

2nd Floor

Facility #

0724

Last Update

14-08-27

Yonge-Eglinton PART – Meeting #6

Davisville JPS /Spectrum Alt SS
Current and Long-Term Room Uses

- Legend:**
- Kindergarten 900+ sq ft
 - Kindergarten 800-900 sq ft
 - Regular Classroom 700+ sq ft
 - Special Education Classroom
 - Specialty Classroom
 - Resource Room 400-700 sq ft
 - Seminar Room <400 sq ft
 - Child Care Exclusive Use
 - Child Care Shared Use
 - # of rooms required by year
 - Room Use
 - Spectrum Regular Classroom 700+ sq ft

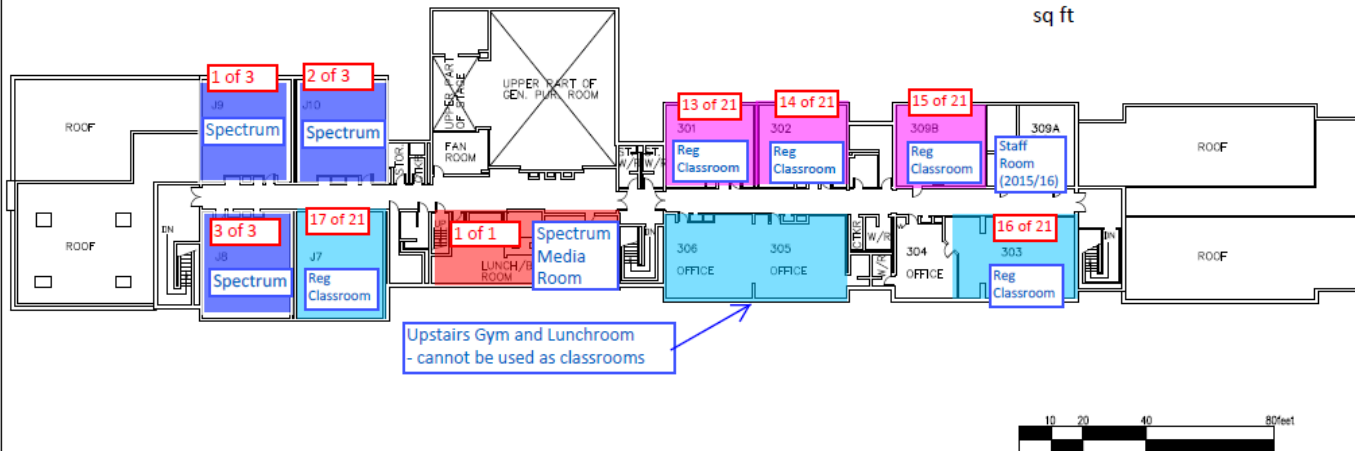

Classroom requirements and uses at most constrained year (2021 onward):

- FDK - 6 (4 reg and 2 FI)
- Reg classrooms - 21 (9 reg and 12 FI)
- Specialty - 3 (2 Davisville, 1 Spectrum)
- Additional Gyms - 1 (Rooms 305 & 306)
- Special Education - 1 (HSP)
- ESL - 2 (Primary and Junior)
- Child Care (Excl.) - 4
- Spectrum - 3
- TOTAL = 41**



If computer lab remains as such, additional portable required in 2016.



Facility Services



Toronto District School Board

Technical Services Division
Design & Construction Unit

15 Oakham Court, Toronto, Ontario M2N 2T3
T: 416-972-4188 / F: 416-972-9724

Facility
Davisville JPS /MS for the Deaf/Spectrum Alt SS
Address
43 Millwood Road
M4S 1J6
TORONTO

Sheet Title
3rd Floor

Facility # 0724	Last Update 14-08-27
--------------------	-------------------------

Yonge-Eglinton PART – Meeting #6

Legend:

- Kindergarten 900+ sq ft
- Kindergarten 800-900 sq ft
- Regular Classroom 700+ sq ft
- Special Education Classroom
- Specialty Classroom
- Resource Room 400-700 sq ft
- Seminar Room <400 sq ft
- Child Care Exclusive Use
- Child Care Shared Use
- # of rooms required by year
- Room Use
- Potential new room (retrofit)

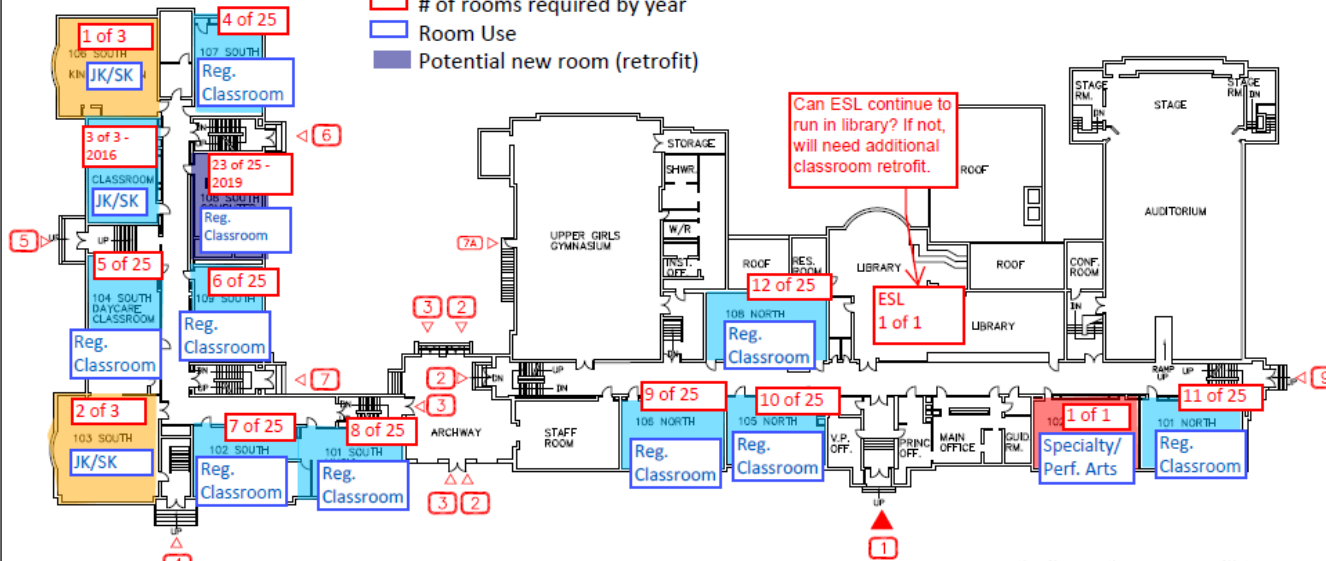

Classroom requirements and uses at most constrained year (2022 onward):

- FDK - 3
- Reg classrooms - 25 (20 Reg. and 5 Ext. French)
- Specialty - 1
- ESL - 1
- Special Education - 11 (1 HSP, 10 Gifted)
- Child Care (Exclusive) - 3
- TOTAL = 44

LEGEND:

- EX. DOOR LABEL XXXXX
- MAIN ENTRANCE ▼
- EXTERIOR DOOR ▼

North Arrow



Facility Services



Technical Services Division
Design & Construction Unit
15 Oakham Cir. Toronto, Ontario M5N 2T5
E: 416-393-4888 / F: 416-393-0734

Facility

**Forest Hill
Jr & Sr PS**

Address
78 Dunlop Road
M5P 2T6
Toronto

Sheet Title

1st Floor

Facility

0764

Last Update

12-06-14

Yonge-Eglinton PART – Meeting #6

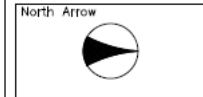
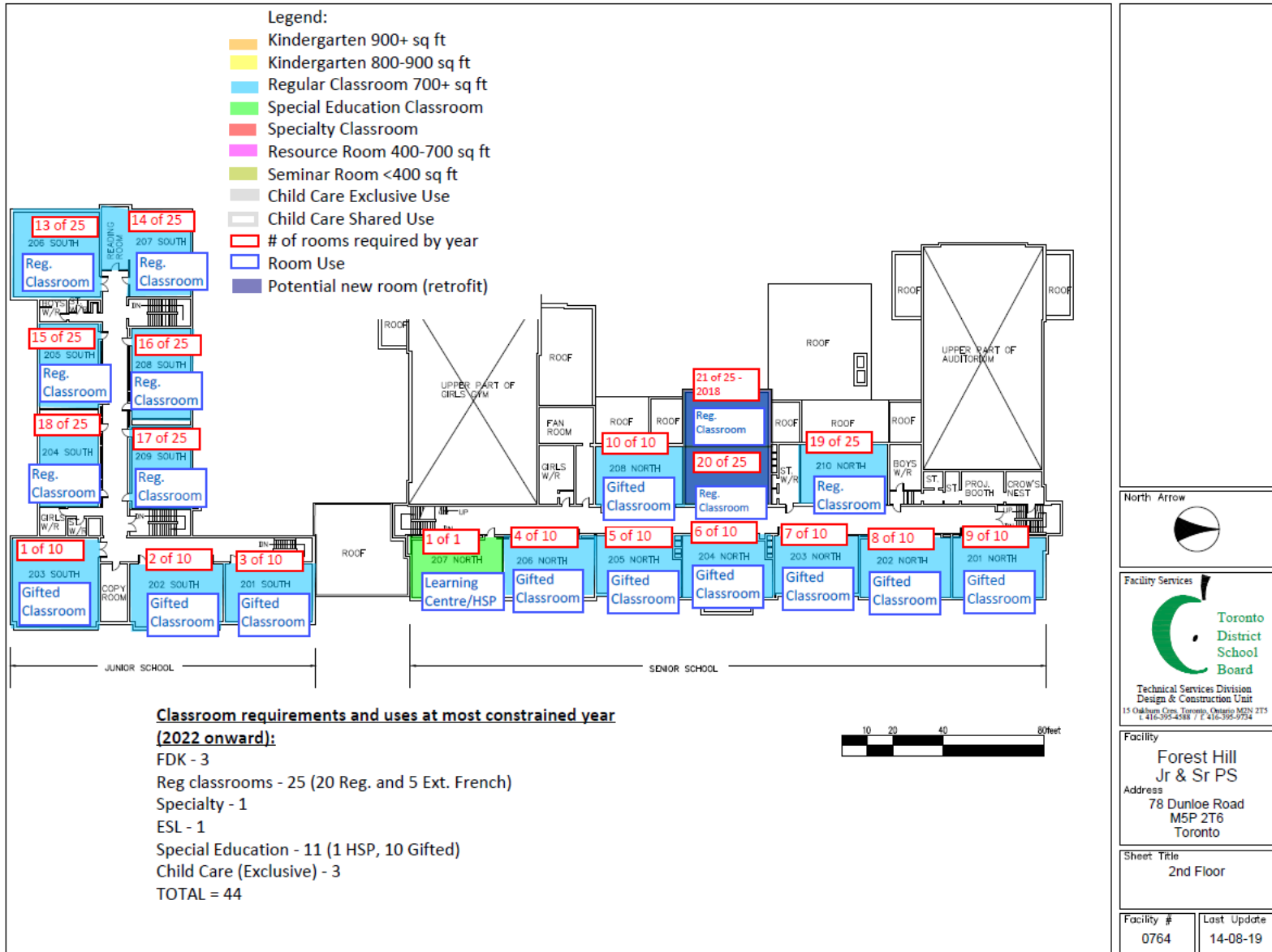

Facility Services
 Toronto District School Board
 Technical Services Division
 Design & Construction Unit
 15 Oakham Cms Toronto, Ontario M2N 2T5
 T 416-395-4588 / F 416-395-9774

Facility
Forest Hill Jr & Sr PS
 Address
 78 Dunloe Road
 M5P 2T6
 Toronto

Sheet Title
2nd Floor

Facility # 0764	Last Update 14-08-19
--------------------	-------------------------

Yonge-Eglinton PART – Meeting #6

Forest Hill Jr. & Sr. PS
Current + Long-Term
Room Uses and Capacity
April 2015

- Legend:**
- Kindergarten 900+ sq ft
 - Kindergarten 800-900 sq ft
 - Regular Classroom 700+ sq ft
 - Special Education Classroom
 - Specialty Classroom
 - Resource Room 400-700 sq ft
 - Seminar Room <400 sq ft
 - Child Care Exclusive Use
 - Child Care Shared Use
 - # of rooms required by year
 - Room Use
 - Potential new room (retrofit)

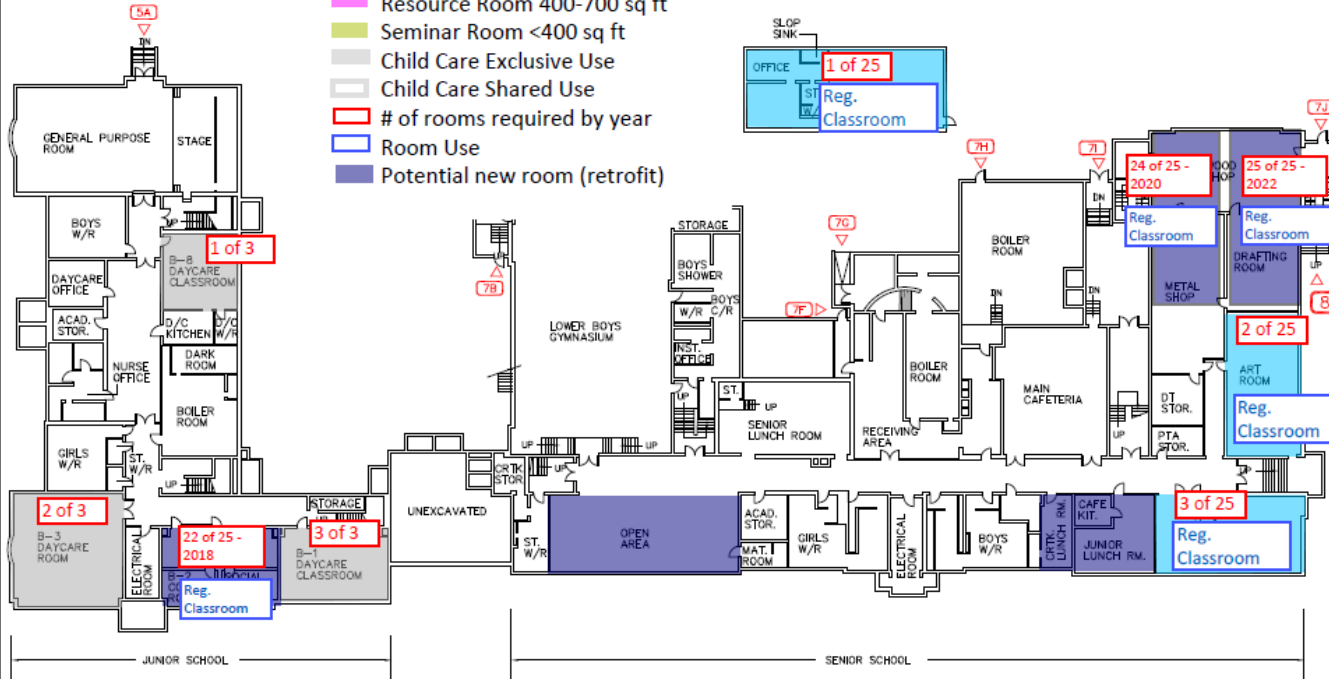

Classroom requirements and uses at most constrained year (2022 onward):

- FDK - 3
- Reg classrooms - 25 (20 Reg. and 5 Ext. French)
- Specialty - 1
- ESL - 1
- Special Education - 11 (1 HSP, 10 Gifted)
- Child Care (Exclusive) - 3
- TOTAL = 44**

LEGEND:

- EX. DOOR LABEL XXXXX
- MAIN ENTRANCE ▼
- EXTERIOR DOOR ▼

North Arrow



Facility Services



Technical Services Division
Designs & Construction Unit
15 Oakburn Cres. Toronto, Ontario M2N 2T5
T. 416-393-4888 / F. 416-393-9734

Facility

Forest Hill Jr & Sr PS
Address
78 Dunlop Road
M5P 2T6
Toronto

Sheet Title

Basement

Facility #

0764

Last Update

12-06-14

Yonge-Eglinton PART – Meeting #6

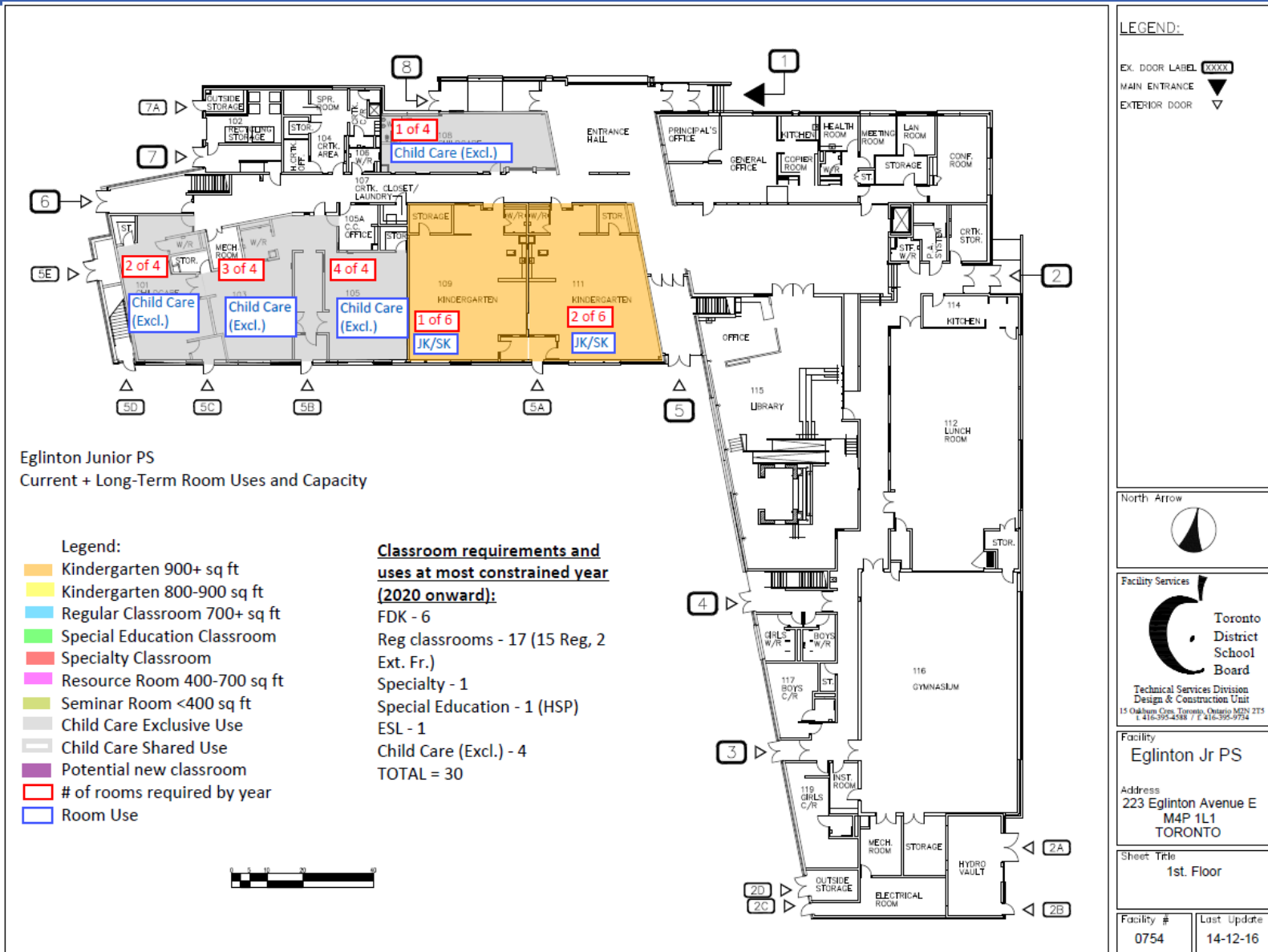

Yonge-Eglinton PART – Meeting #6

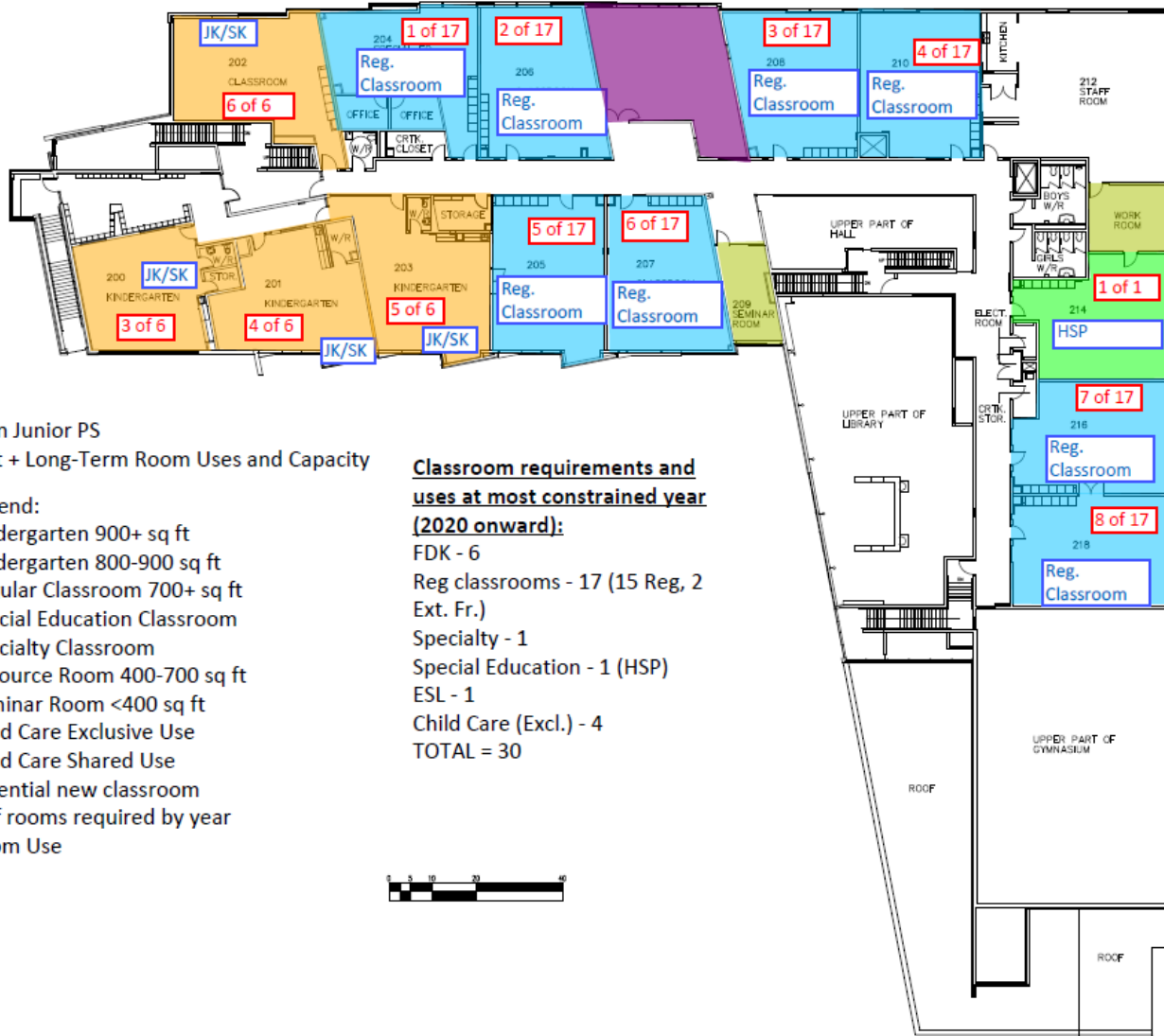

Eglinton Junior PS
Current + Long-Term Room Uses and Capacity

Legend:

- Kindergarten 900+ sq ft
- Kindergarten 800-900 sq ft
- Regular Classroom 700+ sq ft
- Special Education Classroom
- Specialty Classroom
- Resource Room 400-700 sq ft
- Seminar Room <400 sq ft
- Child Care Exclusive Use
- Child Care Shared Use
- Potential new classroom
- # of rooms required by year
- Room Use

Classroom requirements and uses at most constrained year (2020 onward):

- FDK - 6
- Reg classrooms - 17 (15 Reg, 2 Ext. Fr.)
- Specialty - 1
- Special Education - 1 (HSP)
- ESL - 1
- Child Care (Excl.) - 4
- TOTAL = 30**



North Arrow

Facility Services

Toronto District School Board

Technical Services Division
Design & Construction Unit
15 Oakham Crn, Toronto, Ontario M2N 2T5
T: 416-392-4388 / F: 416-395-9734

Facility
Eglinton Jr PS

Address
223 Eglinton Avenue E
M4P 1L1
TORONTO

Sheet Title
2nd. Floor

Facility # 0754	Last Update 12-11-30
--------------------	-------------------------

Yonge-Eglinton PART – Meeting #6

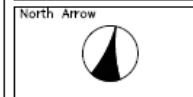
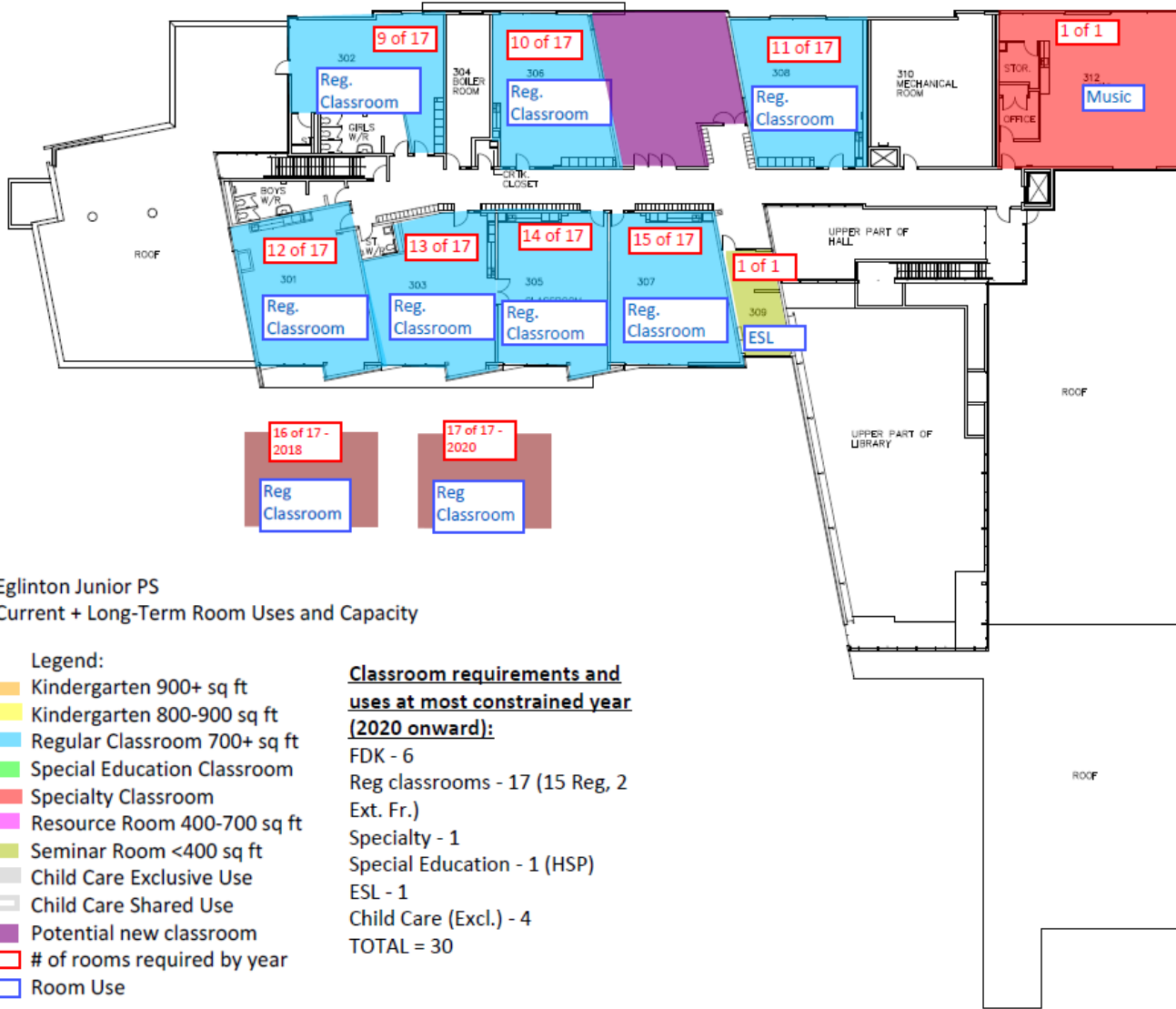

Facility
Eglinton Jr PS
Address
223 Eglinton Avenue E
M4P 1L1
TORONTO

Sheet Title
3rd. Floor

Facility # 0754	Last Update 12-11-30
--------------------	-------------------------

Yonge-Eglinton PART – Meeting #6

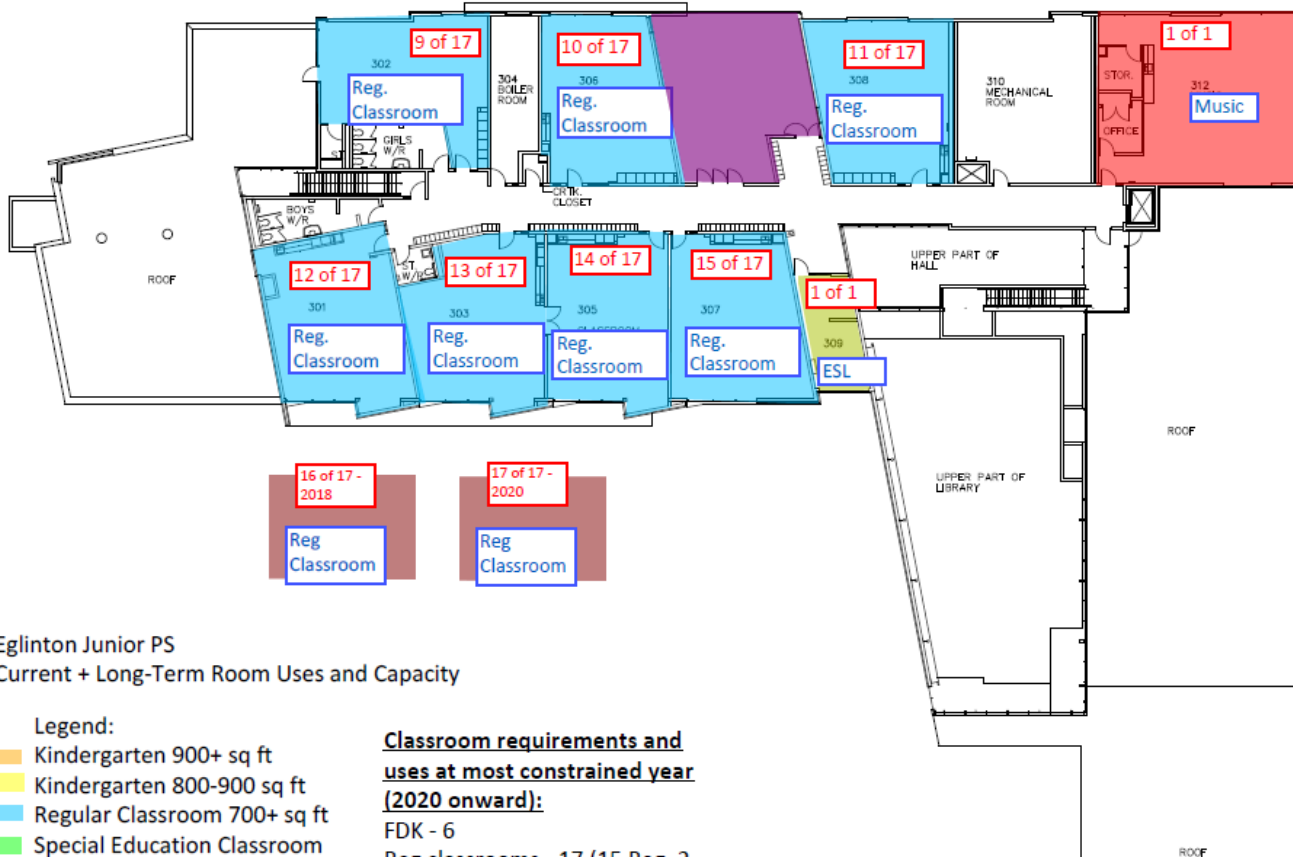

Eglinton Junior PS Current + Long-Term Room Uses and Capacity

Legend:

- Kindergarten 900+ sq ft
- Kindergarten 800-900 sq ft
- Regular Classroom 700+ sq ft
- Special Education Classroom
- Specialty Classroom
- Resource Room 400-700 sq ft
- Seminar Room <400 sq ft
- Child Care Exclusive Use
- Child Care Shared Use
- Potential new classroom
- # of rooms required by year
- Room Use

Classroom requirements and uses at most constrained year (2020 onward):

- FDK - 6
- Reg classrooms - 17 (15 Reg, 2 Ext. Fr.)
- Specialty - 1
- Special Education - 1 (HSP)
- ESL - 1
- Child Care (Excl.) - 4
- TOTAL = 30

North Arrow



Facility Services



Technical Services Division
Design & Construction Unit
15 Oakham Cres. Toronto, Ontario M2N 2T3
L 416-395-4588 / F 416-395-0734

Facility

Eglinton Jr PS

Address
223 Eglinton Avenue E
M4P 1L1
TORONTO

Sheet Title

3rd. Floor

Facility #

0754

Last Update

12-11-30

Yonge-Eglinton PART – Meeting #6

Maurice Cody Junior PS
Current and Long-Term
Room Uses and Capacity

- Legend:**
- Kindergarten 900+ sq ft
 - Kindergarten 800-900 sq ft
 - Regular Classroom 700+ sq ft
 - Special Education Classroom
 - Specialty Classroom
 - Resource Room 400-700 sq ft
 - Seminar Room <400 sq ft
 - Child Care Exclusive Use
 - Child Care Shared Use
 - # of rooms required by year
 - Room Use



Classroom requirements and uses at most constrained year (2023 onward):

- FDK - 8
- Reg classrooms - 21
- Specialty - 1
- Special Education - 1 (HSP)
- TOTAL = 31**

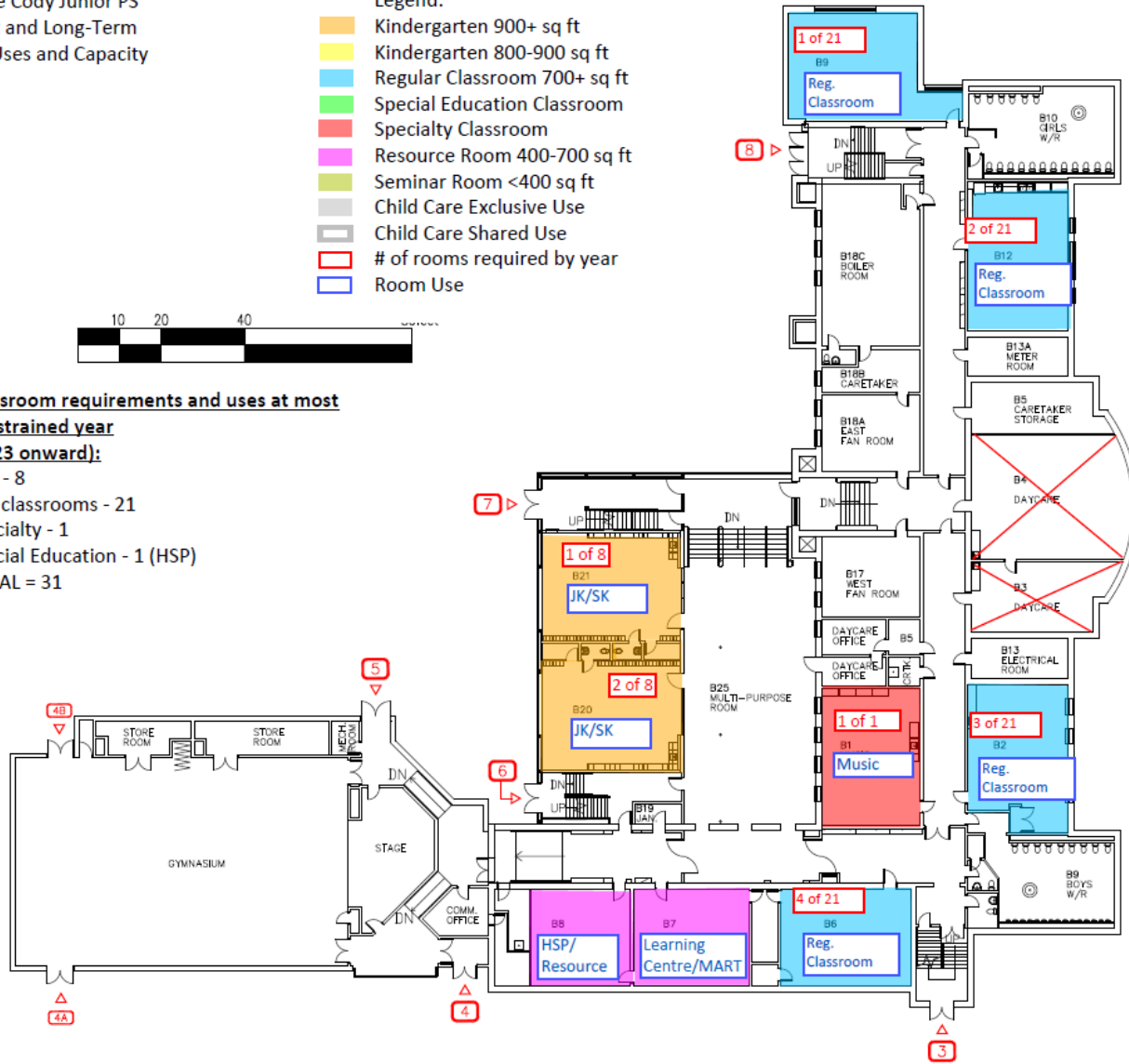

LEGEND:

- EX. DOOR LABEL XXXXX
- MAIN ENTRANCE ▼
- EXTERIOR DOOR ▽

North Arrow



Facility Services



Technical Services Division
Design & Construction Unit
15 Oakham Cres, Toronto, Ontario M2N 2T5
T: 416-995-4389 / F: 416-995-9724

Facility

Maurice Cody JPS
Address
364 Belsize Drive
M4S 1M7
TORONTO

Sheet Title

Basement

Facility #

0633

Last Update

14-12-16

Yonge-Eglinton PART – Meeting #6

Maurice Cody Junior PS
Current and Long-Term
Room Uses and Capacity

- Legend:**
- Kindergarten 900+ sq ft
 - Kindergarten 800-900 sq ft
 - Regular Classroom 700+ sq ft
 - Special Education Classroom
 - Specialty Classroom
 - Resource Room 400-700 sq ft
 - Seminar Room <400 sq ft
 - Child Care Exclusive Use
 - Child Care Shared Use
 - # of rooms required by year
 - Room Use



Classroom requirements and uses at most constrained year (2023 onward):

- FDK - 8
- Reg classrooms - 21
- Specialty - 1
- Special Education - 1 (HSP)
- TOTAL = 31**

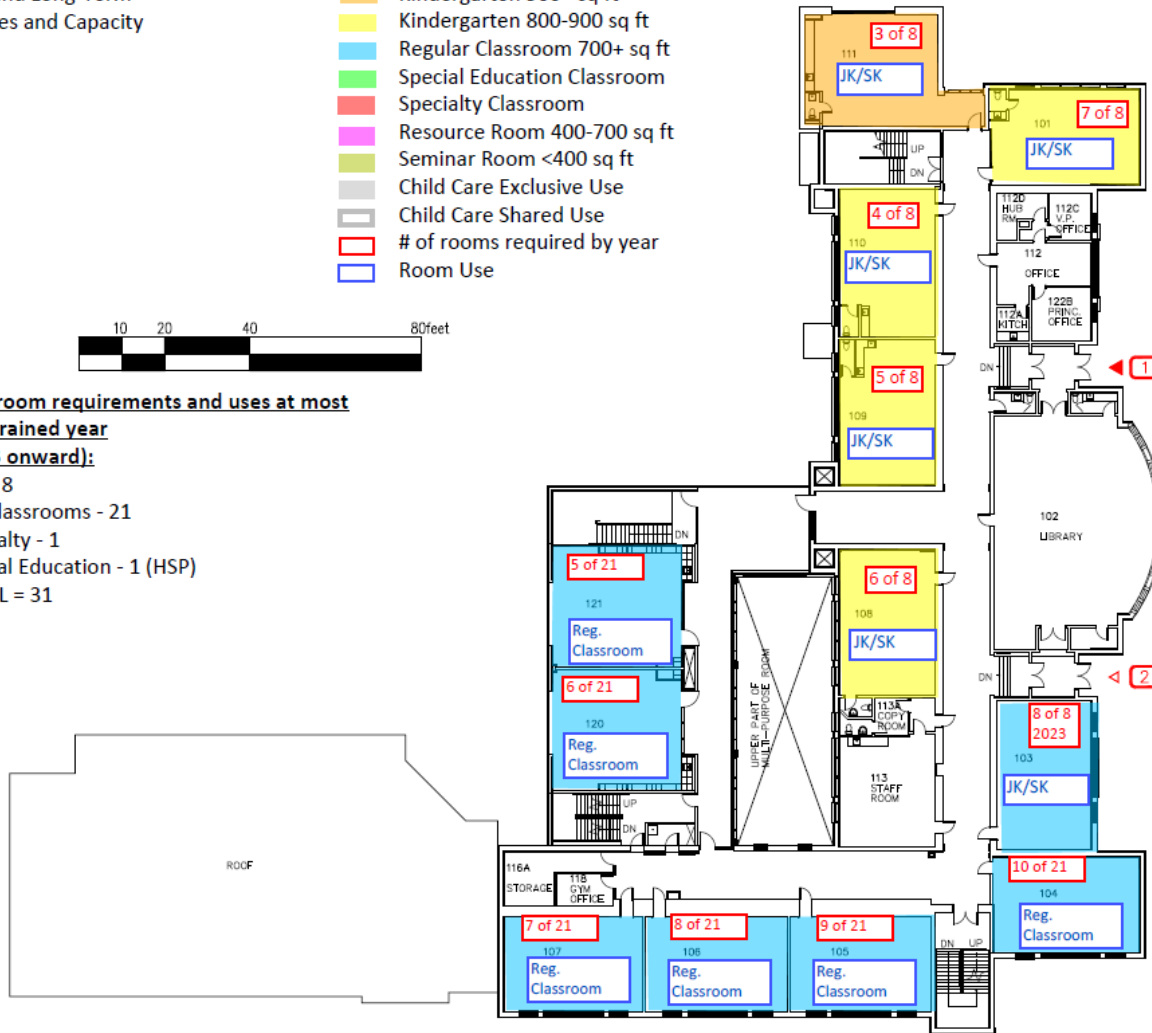

LEGEND:

- EX. DOOR LABEL: XXXXX
- MAIN ENTRANCE: ▼
- EXTERIOR DOOR: ▼

North Arrow

Facility Services



Facility

Maurice Cody JPS
Address
364 Belsize Drive
M4S 1M7
TORONTO

Sheet Title
1st Floor

Facility #	Last Update
0633	14-12-16

Yonge-Eglinton PART – Meeting #6

Maurice Cody Junior PS
Current and Long-Term
Room Uses and Capacity

- Legend:
- Kindergarten 900+ sq ft
 - Kindergarten 800-900 sq ft
 - Regular Classroom 700+ sq ft
 - Special Education Classroom
 - Specialty Classroom
 - Resource Room 400-700 sq ft
 - Seminar Room <400 sq ft
 - Child Care Exclusive Use
 - Child Care Shared Use
 - # of rooms required by year
 - Room Use



Classroom requirements and uses at most constrained year

(2023 onward):
 FDK - 8
 Reg classrooms - 21
 Specialty - 1
 Special Education - 1 (HSP)
 TOTAL = 31

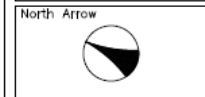
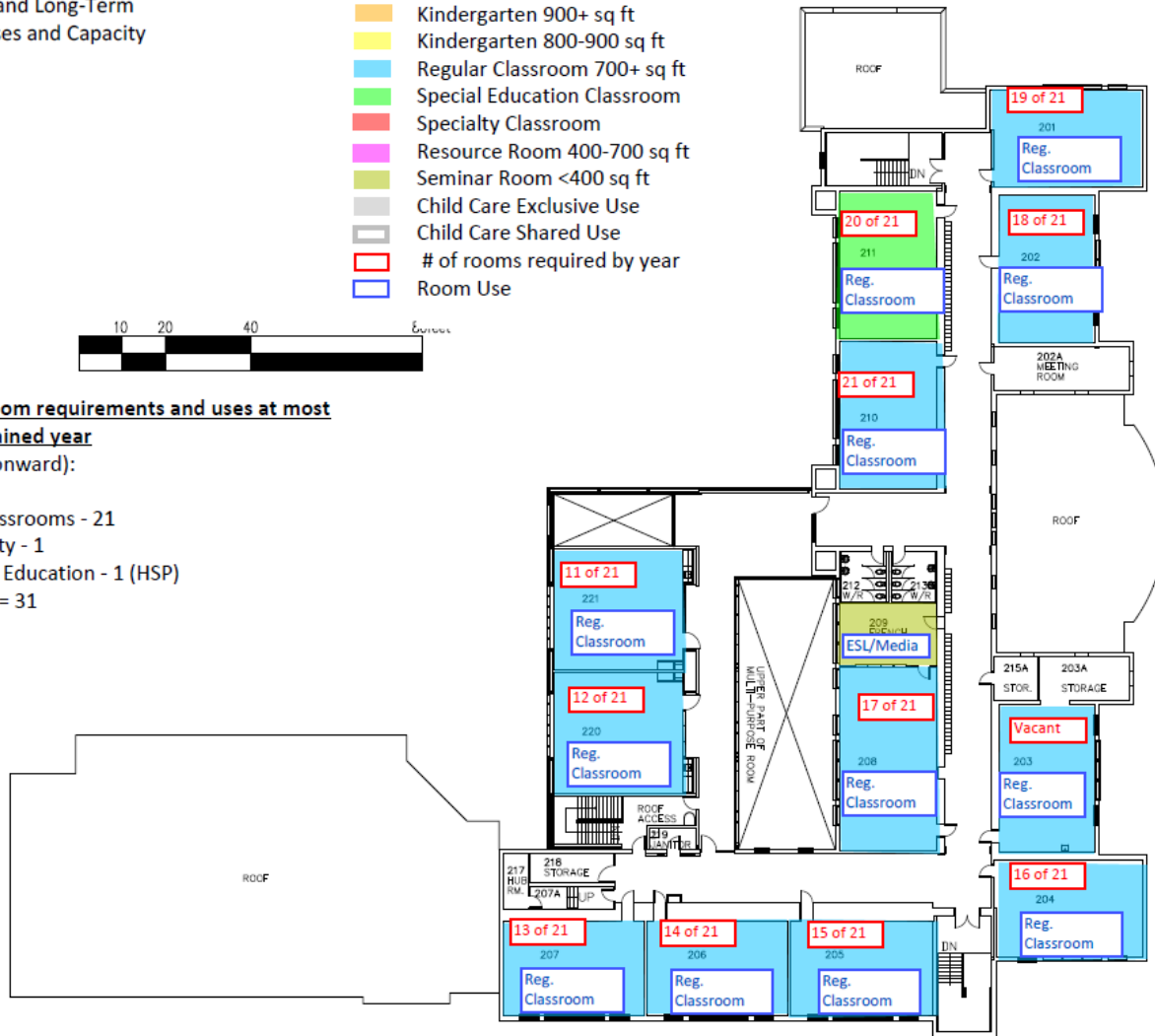

Facility Services

 Toronto District School Board
 Technical Services Division
 Design & Construction Unit
 15 Oakham Court, Toronto, Ontario M2N 2T3
 T: 416-992-4589 / F: 416-992-9724

Facility
Maurice Cody JPS
 Address
 364 Belsize Drive
 M4S 1M7
 TORONTO

Sheet Title
 2nd. Floor

Facility # 0633	Last Update 13-11-21
--------------------	-------------------------

Yonge-Eglinton PART – Meeting #6

Oriole Park Public School
Current and Long-Term
Room Uses and Capacity

**Classroom requirements and uses at
most constrained year**

(2015 and 2016):
FDK - 3
Reg classrooms - 10
Specialty - 1
Special Education - 1 (HSP)
Child Care (Exclusive) - 2
TOTAL = 17

- Legend:**
- Kindergarten 900+ sq ft
 - Kindergarten 800-900 sq ft
 - Regular Classroom 700+ sq ft
 - Special Education Classroom
 - Specialty Classroom
 - Resource Room 400-700 sq ft
 - Seminar Room <400 sq ft
 - Child Care Exclusive Use
 - Child Care Shared Use
 - # of rooms required by year
 - Room Use

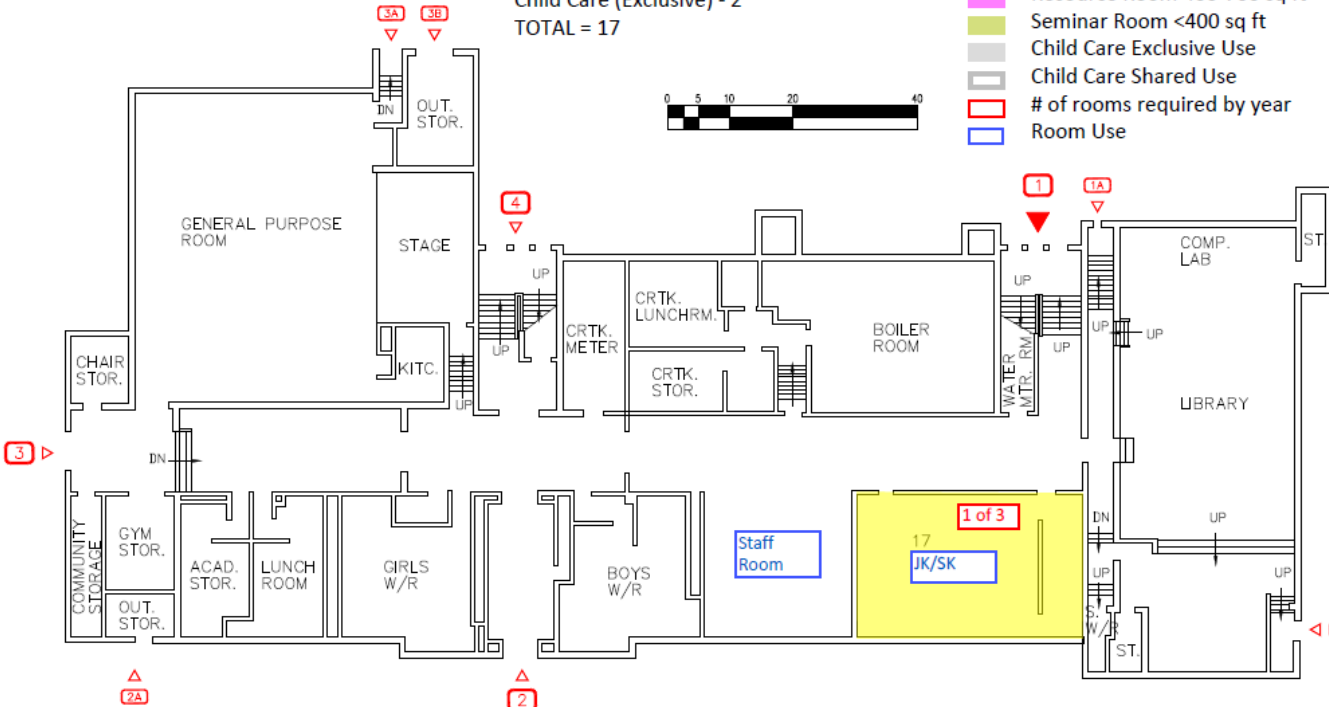

LEGEND:

EX. DOOR LABEL: XXXXX
 MAIN ENTRANCE: ▼
 EXTERIOR DOOR: ▽

North Arrow

Facility Services

 Toronto District School Board
 Technical Services Division
 Design & Construction Unit
 15 Oakburn Court, Toronto, Ontario M2N 2T5
 T: 416-395-4588 / F: 416-395-9734

Facility
Oriole Park PS
 Address
 80 Braemar Avenue
 M5P 2L4
 Toronto

Sheet Title
Basement

Facility #	Last Update
0667	14-12-16

Yonge-Eglinton PART – Meeting #6

Oriole Park Public School
Current and Long-Term
Room Uses and Capacity

**Classroom requirements and uses at
most constrained year**

(2015 and 2016):

- FDK - 3
- Reg classrooms - 10
- Specialty - 1
- Special Education - 1 (HSP)
- Child Care (Exclusive) - 2
- TOTAL = 17

- Legend:**
- Kindergarten 900+ sq ft
 - Kindergarten 800-900 sq ft
 - Regular Classroom 700+ sq ft
 - Special Education Classroom
 - Specialty Classroom
 - Resource Room 400-700 sq ft
 - Seminar Room <400 sq ft
 - Child Care Exclusive Use
 - Child Care Shared Use
 - # of rooms required by year
 - Room Use

LEGEND:

- EX. DOOR LABEL XXXX
- MAIN ENTRANCE ▼
- EXTERIOR DOOR ▽

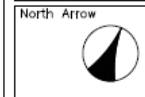
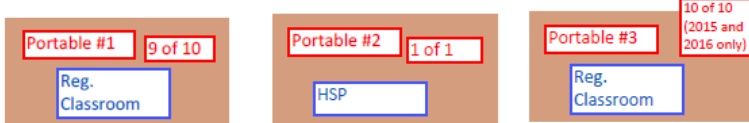
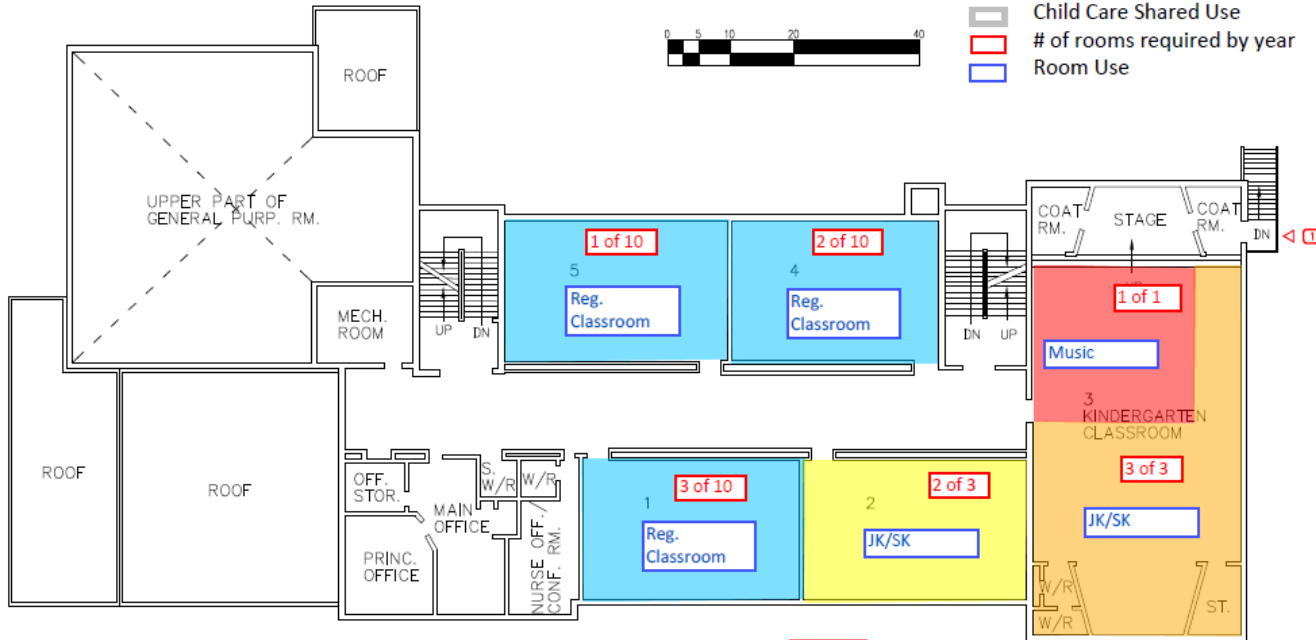

Facility Services

Toronto District School Board
Technical Services Division
Design & Construction Unit
15 Oakham Cres, Toronto, Ontario M5Y 2T5
T: 416-995-4888 / F: 416-995-9724

Facility
Oriole Park PS
Address
80 Braemar Avenue
M5P 2L4
Toronto

Sheet Title
1st. Floor

Facility #	Last Update
0667	14-12-16

Yonge-Eglinton PART – Meeting #6

Orlie Park Public School
Current and Long-Term Room Uses and Capacity

**Classroom requirements and uses at
most constrained year**

(2015 and 2016):

- FDK - 3
- Reg classrooms - 10
- Specialty - 1
- Special Education - 1 (HSP)
- Child Care (Exclusive) - 2
- TOTAL = 17



Legend:

- Kindergarten 900+ sq ft
- Kindergarten 800-900 sq ft
- Regular Classroom 700+ sq ft
- Special Education Classroom
- Specialty Classroom
- Resource Room 400-700 sq ft
- Seminar Room <400 sq ft
- Child Care Exclusive Use
- Child Care Shared Use
- # of rooms required by year
- Room Use

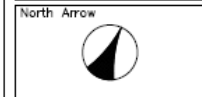
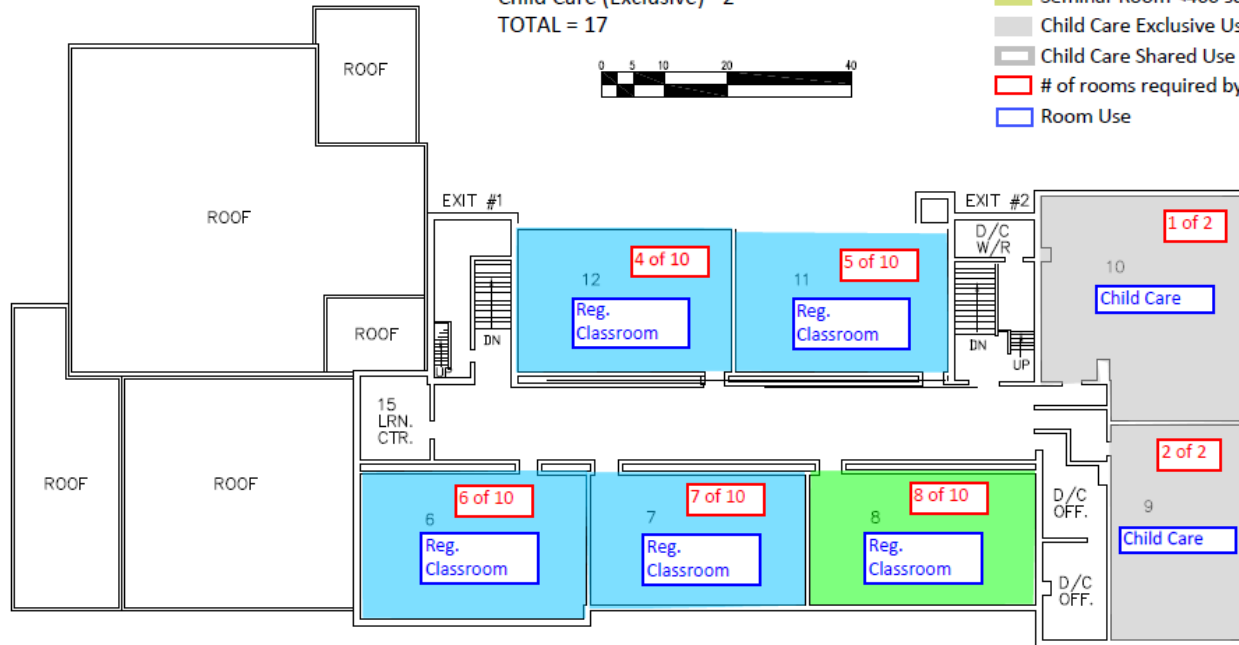

Facility Services

 Toronto District School Board
 Technical Services Division
 Design & Construction Unit
 15 Oakburn Cres. Toronto, Ontario M2N 2T5
 T. 416-391-4588 / F. 416-395-9734

Facility
Orlie Park PS
 Address
 80 Braemar Avenue
 M5P 2L4
 Toronto

Sheet Title
 2nd. Floor

Facility #	Last Update
0667	09-12-07

Planning for November 17th Public Meeting

- World café style
- 11 individual stations
 - PART Recommended Model
 - Enrolment projections (status quo vs. model)
 - Boundary changes
 - French changes
 - Capital Improvements
 - Davisville Jr. PS/Spectrum Alternative School
 - Eglinton Jr. PS
 - Maurice Cody Jr. PS
 - Oriole Park Jr. PS
 - Forest Hill Jr. & Sr. PS
 - Hodgson Sr. PS
- Transitions will be discussed at school stations

Existing Junior, Intermediate, and Senior Attendance Area Boundaries for Schools in the Yonge-Eglinton Review

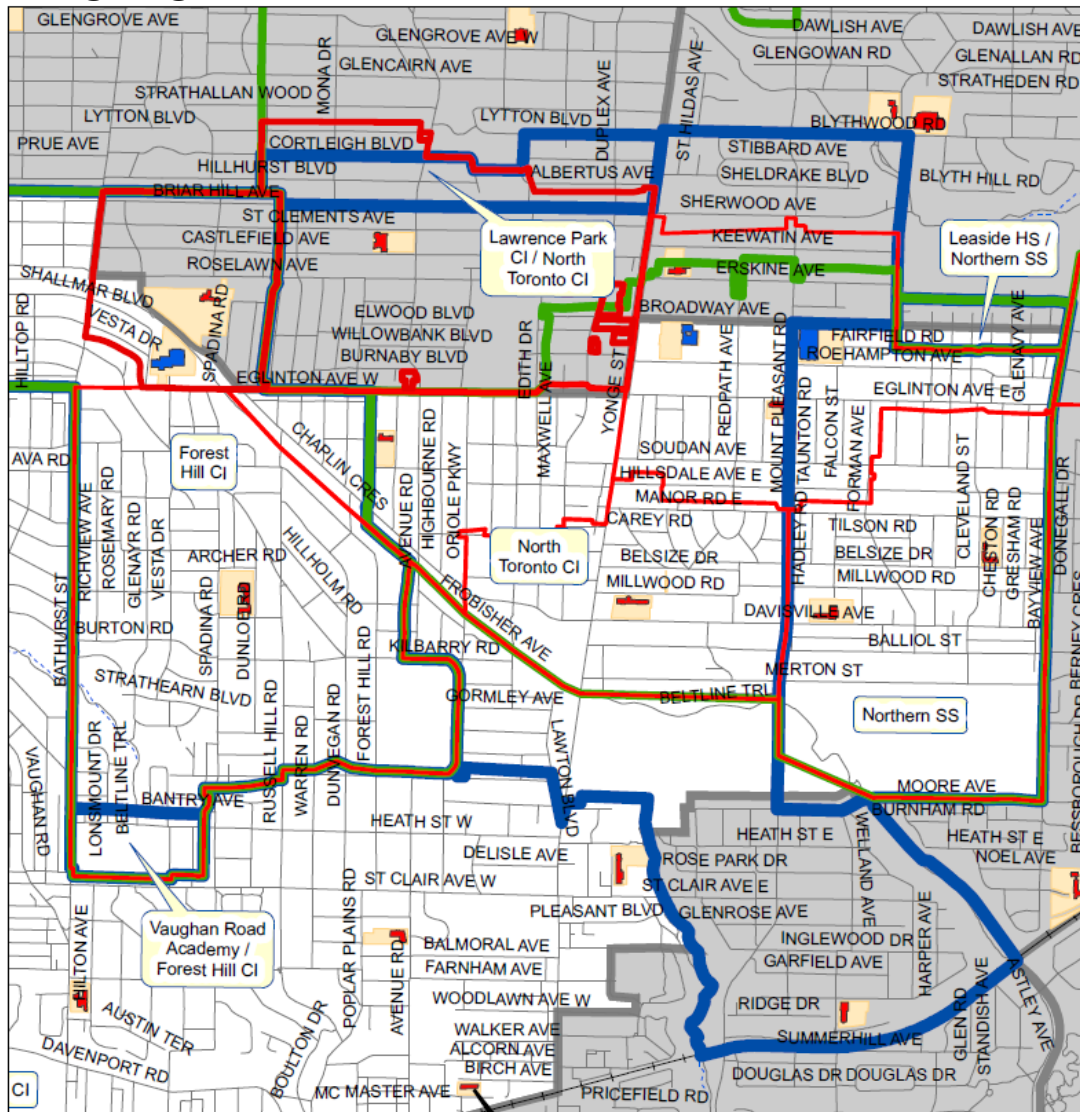

Legend:

- Junior Attendance Area
- Intermediate Attendance Area
- Secondary Attendance Area
- Ward Boundary
- Road
- Railway
- Utilityline
- Waterway
- Elementary School
- Secondary School
- Other Facility
- Site

Please note:
The lines on this map representing the Attendance Areas are approximate.
For specific information on designated schools to serve individual addresses, please consult the TDSB Street Guide.

0 0.15 0.3 0.6 0.9 1.2 km

Produced by:
Planning Division, TDSB
September 2015

Source:
Base Map - Geospatial Competency Centre
Facility - Planning Division, TDSB
Data - City of Toronto

