

New Bloor CI / ALPHA II Building

- Capacity of the new building will be 924 pupil places.
- Site is being planned to accommodate expansion up to 1,200 pupil places if required in the future (this is a standard part of developing a master plan for a school site).
- Estimated cost is \$34 million – funded by a Ministry of Education grant and TDSB proceeds of disposition (pending approval from EDU).
- New building is being designed by Snyder Architects.



Source: Snyder Architects

New Bloor CI / ALPHA II Building

- Demolition of Brockton building started on January 10, 2019 – interior demolition is underway. Anticipated Completion – August, 2019
- A general contractor will be hired in the summer/ fall of 2019 to construct the new building.
- Construction is anticipated to begin in fall 2019.
- The construction duration is anticipated to be 24 months.
- As of October 31, 2018, the enrolment of Bloor CI was 846 and ALPHA II was 23 (total of 869 students).



Bloor Dufferin Redevelopment

- 7.326 acres conditional sales agreement to Capital Developments, Metropia and Timbercreek Asset Management.
- Proposed mixed-use development to include housing, retail/commercial and office space, a park, a 30,000 sq. ft. community hub, and re-envisioned heritage space (former Kent Sr PS).
- Ministry of Education is contributing \$7 million towards a licensed child care, which would be located in the community hub.

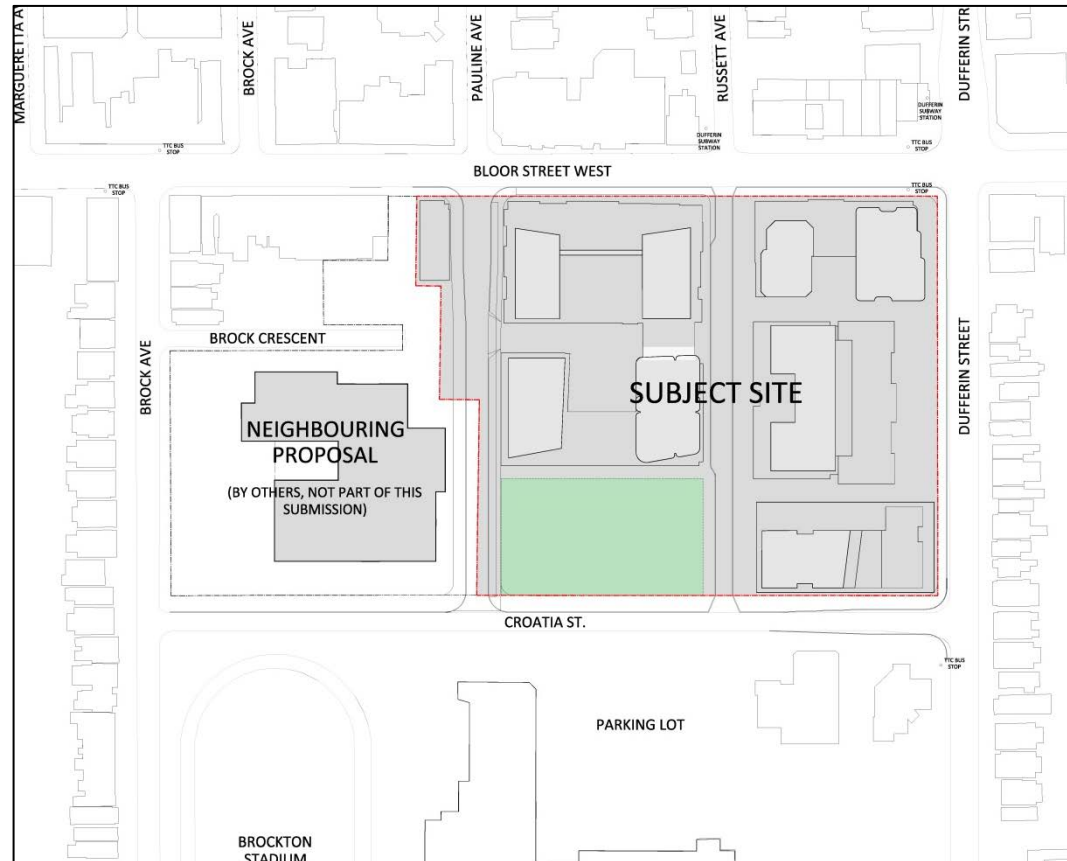

Source: Hariri Pontarini Architects

Overview



Source: GoogleMaps