



# THE REDEVELOPMENT OF DAVISVILLE JUNIOR PUBLIC SCHOOL & SPECTRUM ALTERNATIVE SCHOOL

Community Meeting

20 September 2016

#	ITEM	ACTION
1.1	Welcome and Introductions	Superintendent Ian Allison
1.2	Greetings from Elected Representatives	Trustee Shelley Laskin Councilor Josh Matlow
1.3	Background, Context, Design Principles, Next Steps	Senior Manager of Design David Percival
1.4	Consultant's Experience Project Vision Site-Facts, Parameters, Constraints	Snyder Architects
1.5	Feedback, Questions & Answers	Superintendent Ian Allison

# 2012 LOCAL SCHOOL COMMUNITY DESIGN TEAM VISION

To create a vibrant, sustainable, 21st Century school & community hub which:

- Is fully integrated with the neighbourhood.
- Provides an exceptional teaching and learning setting.
- Provides a dynamic place for the community to connect with one another in quality open spaces and new community facilities.

- Create a model school for 21st Century learning, including an early learning hub & grade 7&8 experiential learning lab for Spectrum.
- Create an open, 'porous' and articulated built form of school facilities and green spaces.
- Plan the school for a single phase of construction to minimize disruption and student displacement.
- Design the school with flexibility to respond to changing program needs.

- Optimize open space to provide a playing field.
- Ensure access to sunlight during outdoor activities (i.e. recess, lunch & play times).
- Provide consolidated, accessible and safe school yard that can accommodate a diversity of student needs.
- Integrate open space with green terraces, courtyards and roofs.
- Create open and welcoming access from Millwood Road.
- Create a new face at Davisville Avenue.
- Open space to be an equivalent amount to existing open space.

## CIRCULATION

- Improve existing vehicular circulation around and to the site while ensuring safety and security throughout the school yard.
- Provide safe and convenient locations for bus loading and passenger drop-off/pick-up.
- Ensure a continuous north-south linear park through the site to allow pedestrian circulation linking Davisville Ave & Millwood Rd.
- Connect pedestrian circulation to the network of open space north and south of the site.

- Nov 2015 – Ministry of Education (EDU) funding approval to construct a replacement school for Davisville JPS & Spectrum Alternative.
- Sept 2016 – EDU funding approval for the Child Care Centre.
- July 2016 – City Council approved a contribution to the project toward community hub components in the new school – 3rd gym, recreation office, underground parking, 3 storey school premium.

Made up of:

- Principal Farrelly and staff from the Board
- Trustee
- Superintendent of Education
- Snyder Architects
- Toronto Children's Services
- Parks Forestry and Recreation



- Develop several options for discussion.
- Vet the options, and identify attributes of the options to be incorporated in the design.
- Distill the options into one preferred option to recommend to the New School Review Team.

Made up of:

- Principal
- Trustee
- Superintendent of Education
- Snyder Architects
- Davisville and Spectrum parents
- Toronto Children's Services
- Parks, Forestry & Recreation
- Community representatives

- Reviews preferred option.
- Provides input to help inform the development of the design.
- Signs off on the schematic design.

- Develop several options for discussion.
- Vet the options, and identify attributes of the options to be incorporated in the design.
- Distill the options into one preferred option to recommend to the New School Review Team.
- Construction Start Summer 2018.
- School Opening September 2020.

# SNYDER ARCHITECTS

## INTRODUCTION



# SNYDER ARCHITECTS

## SCHOOL EXPERTISE

- 36 years of experience in K-12 design + construction.
- Completed over 200 elementary and secondary school projects.
- \$228 million in school construction in the last 5 years.
- Featured/Major contributor to Catapult Schools.

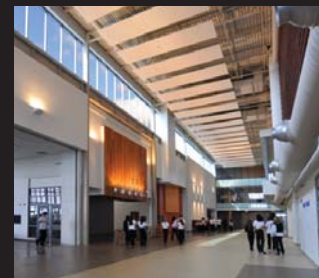
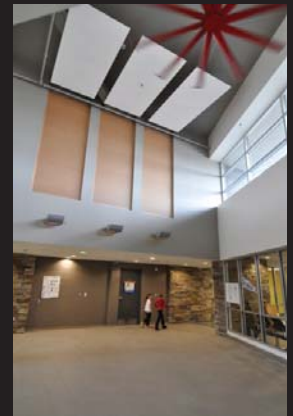
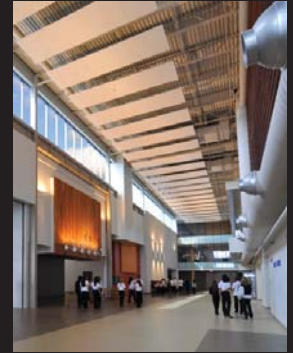

## CONSTRUCTION ON OCCUPIED SCHOOL SITES

### GDHS REDEVELOPMENT – PHASING

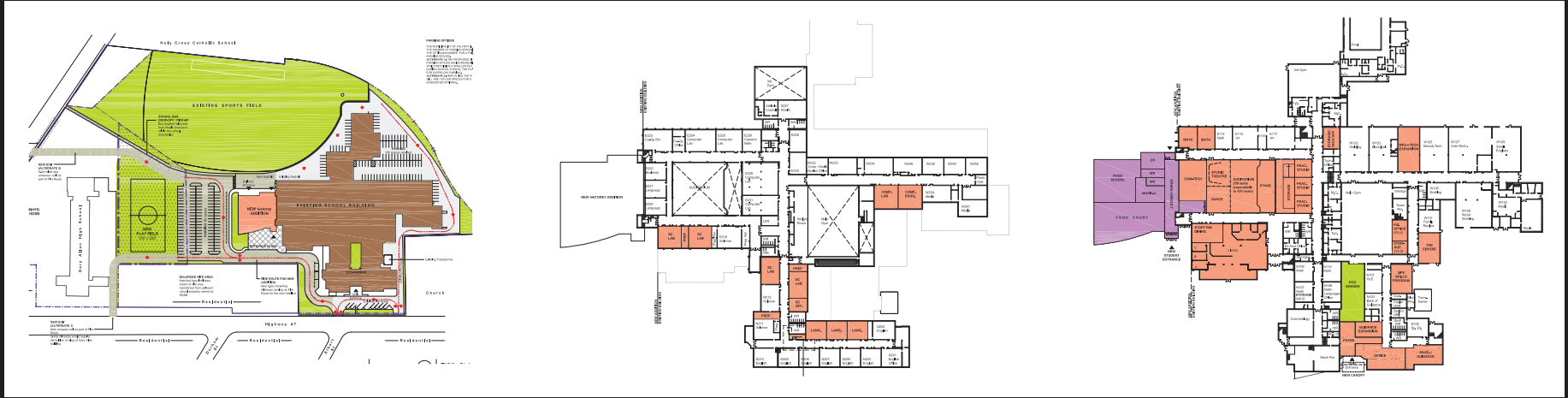

### ST. CONRAD CES – PHASING

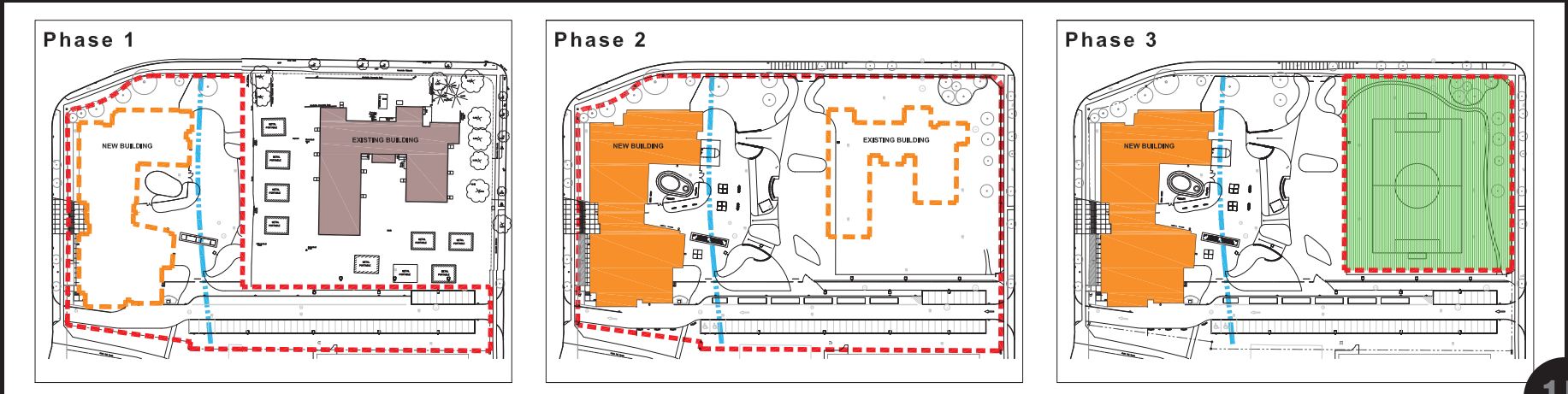

## Snyder Architects

### Senior Team Leadership Dedicated to this Project

Doug Snyder Principal-In-Charge

Avinash Garde Principal, Project Architect

Rochelle Moncarz Senior Architect

Anil Gokarn Principal, Construction

Ellard Willson Engineering Ltd. | mechanical / electrical

Kalos Engineering Inc. | structural

Flora Designs Inc. | civil

PMA Landscape Architects | landscape / arborist



# PROJECT VISION



NATURAL LIGHT AND TRANSPARENCY



# PROJECT VISION



## MULTIPLE PATHWAYS TO LEARNING



# PROJECT VISION



# VALUE OF COMMUNITY CONNECTIONS



# PROJECT VISION



A COOL PLACE WHERE KIDS WANT TO BE



# SITE PARAMETERS

# SITE PARAMETERS

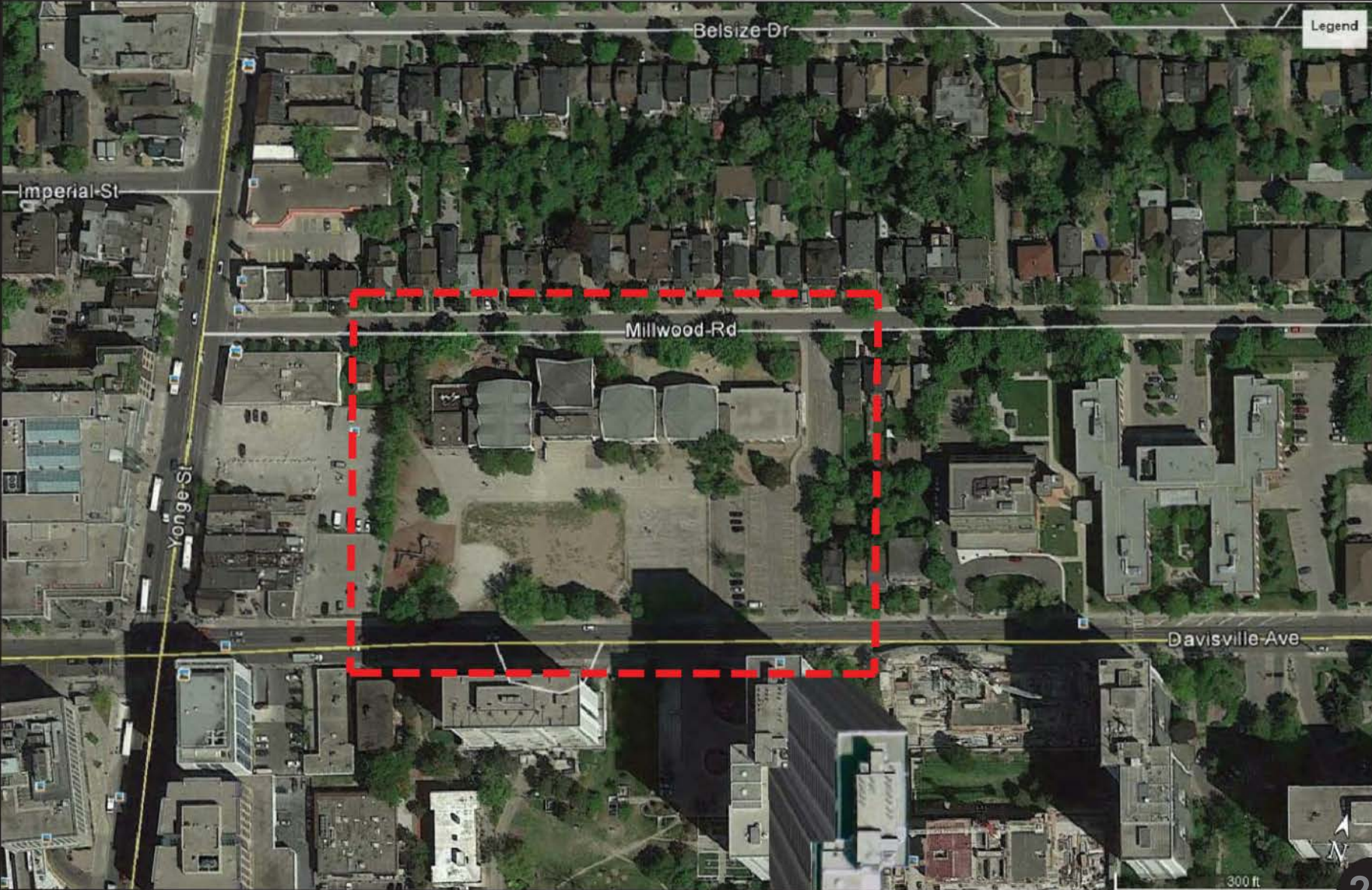

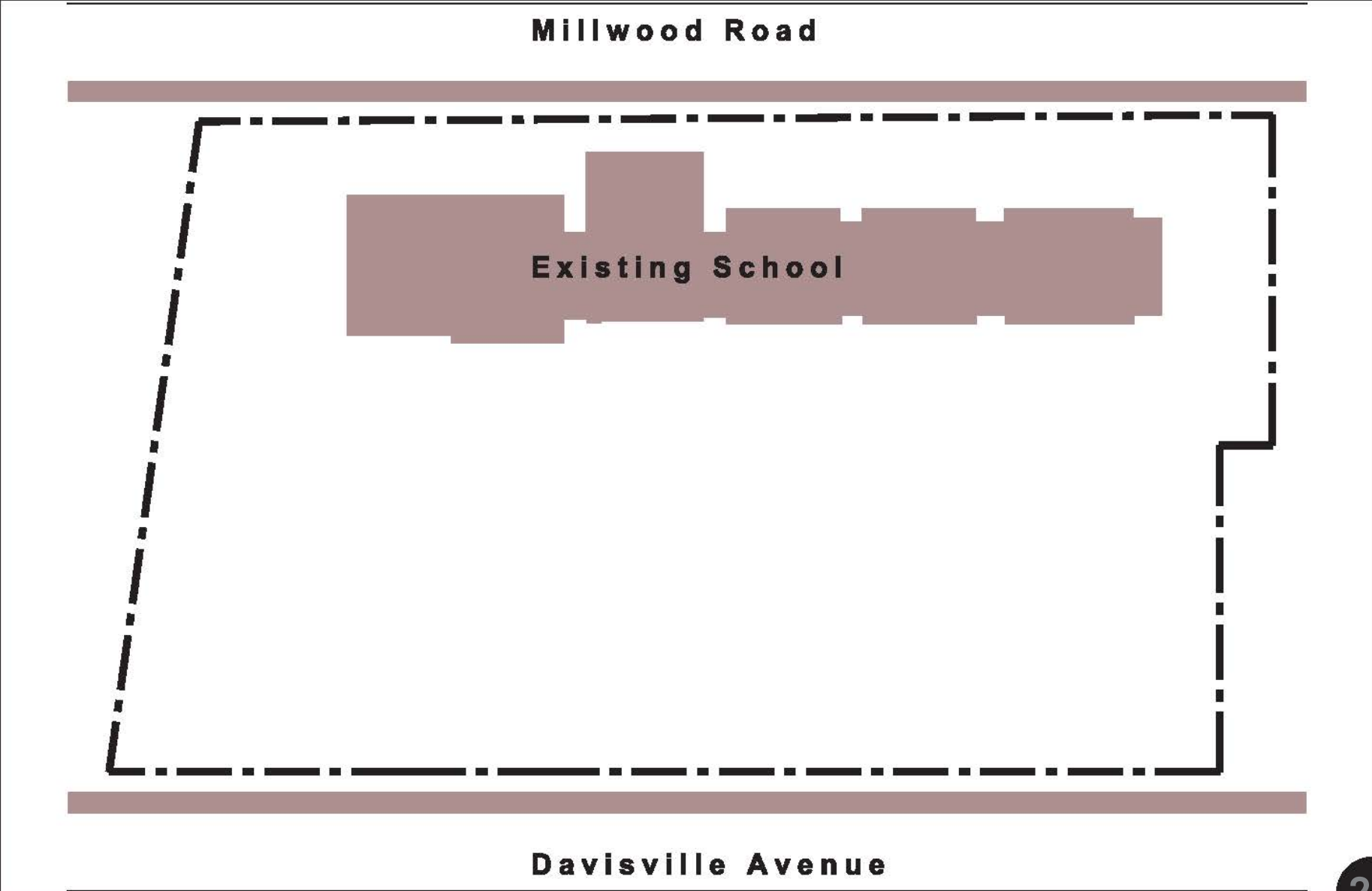

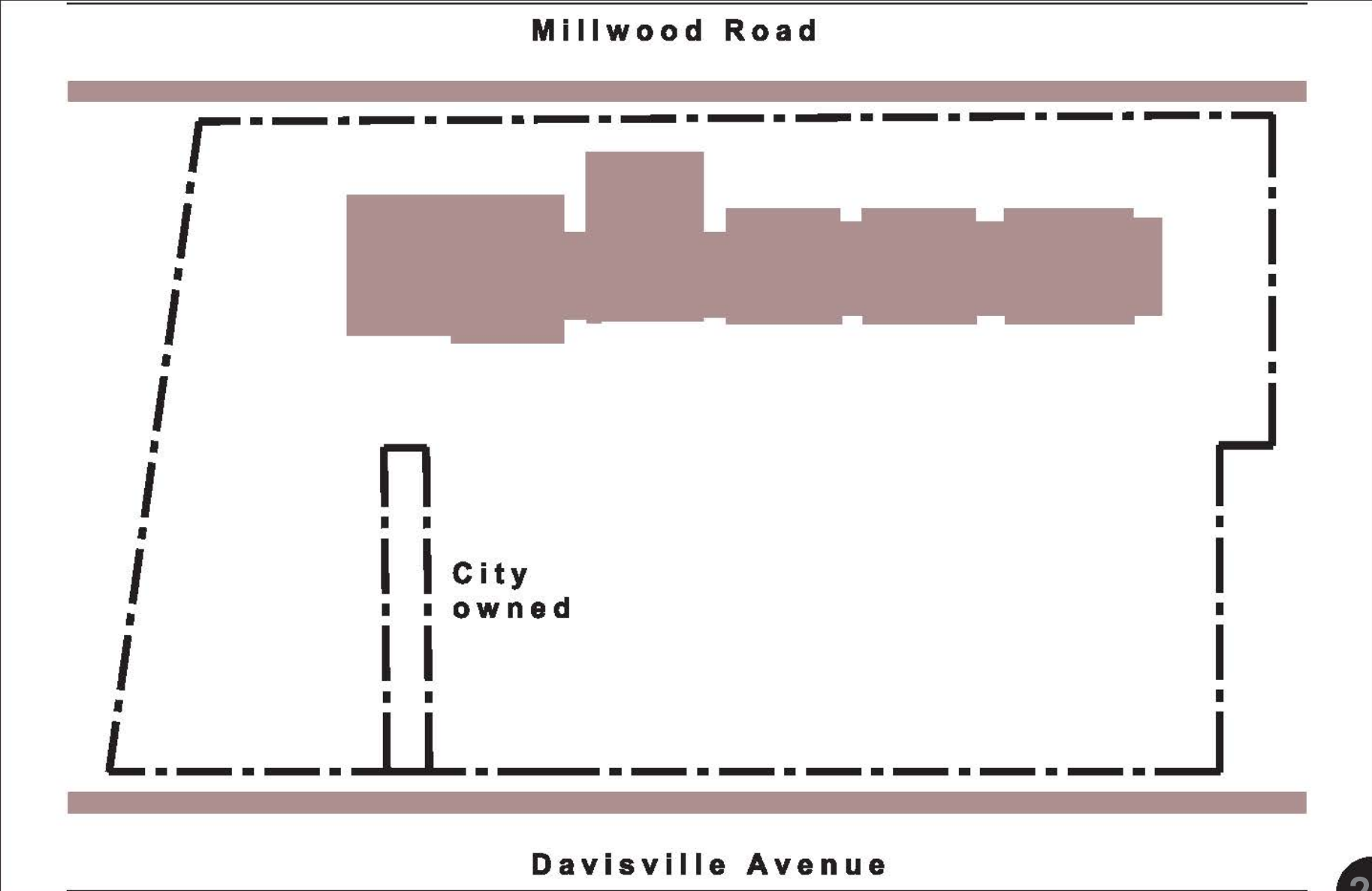



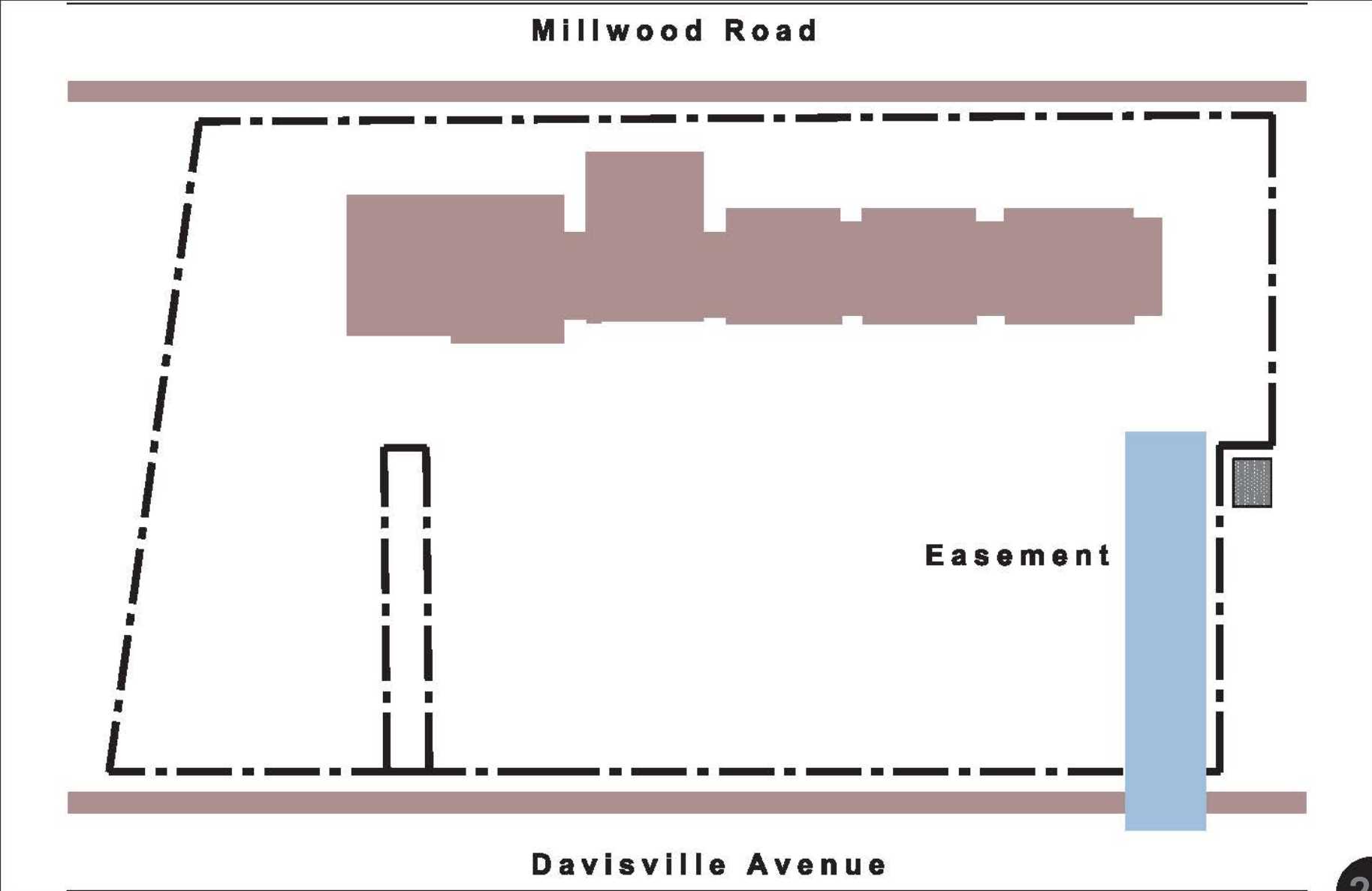

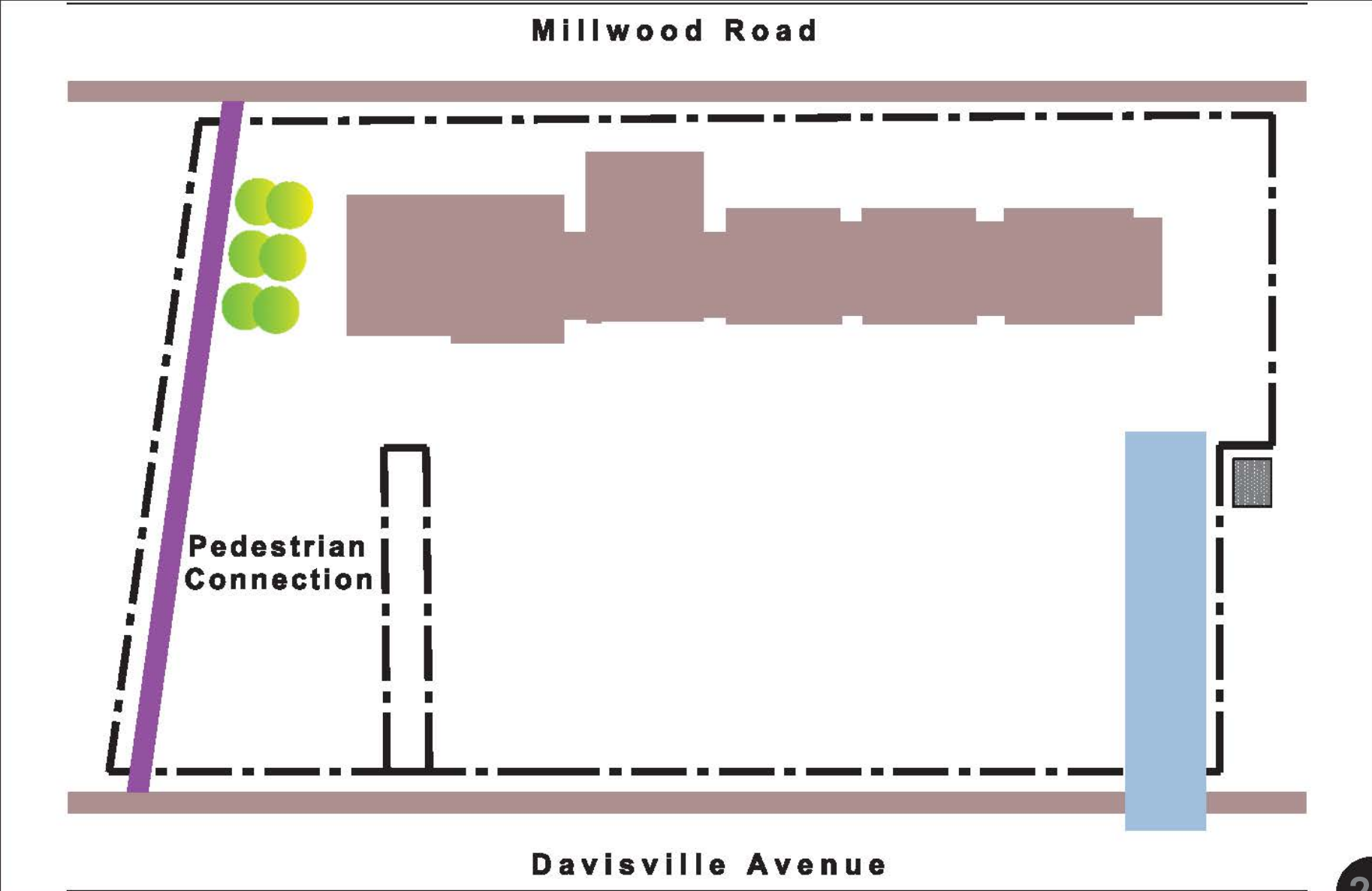

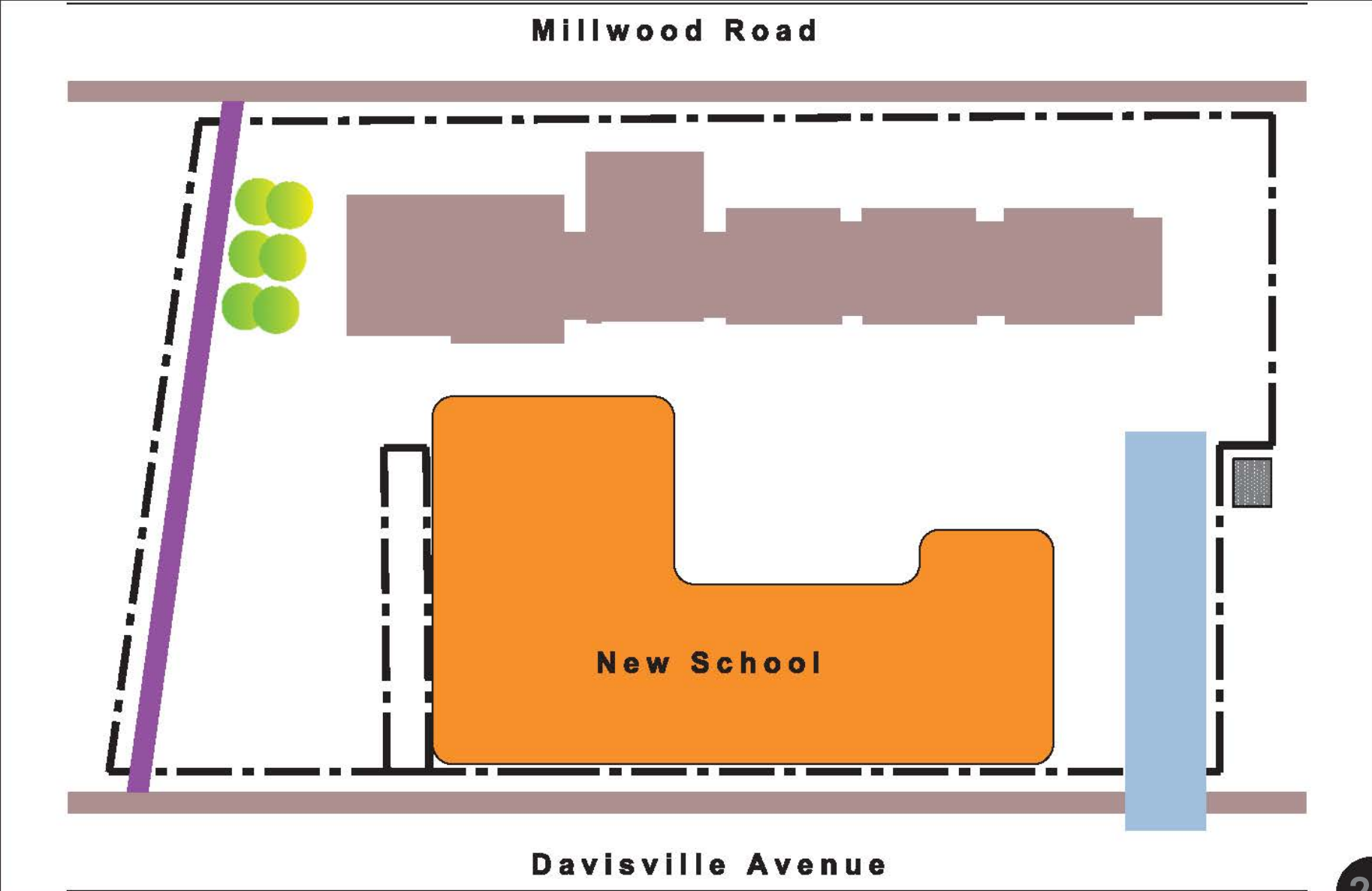

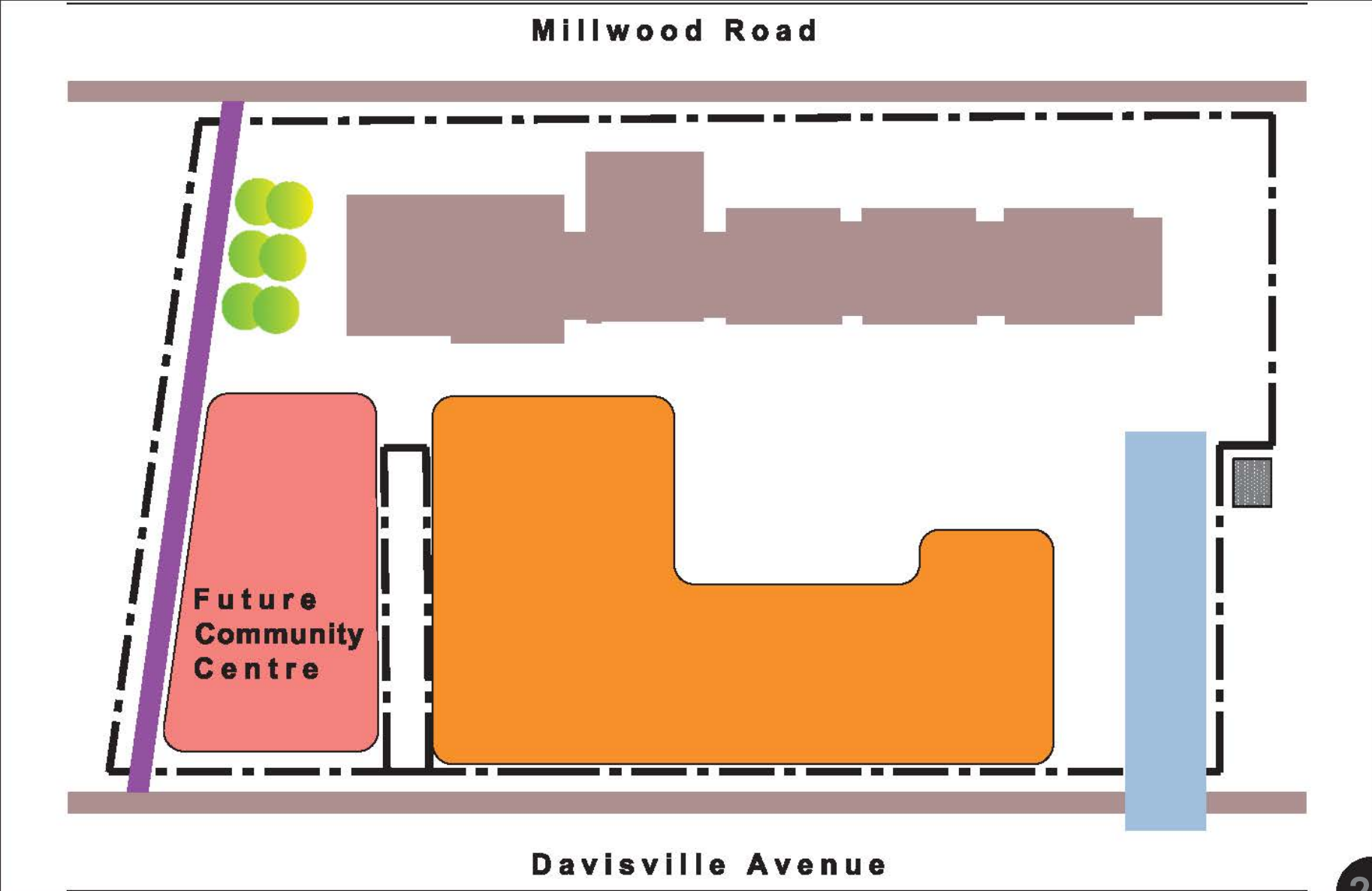

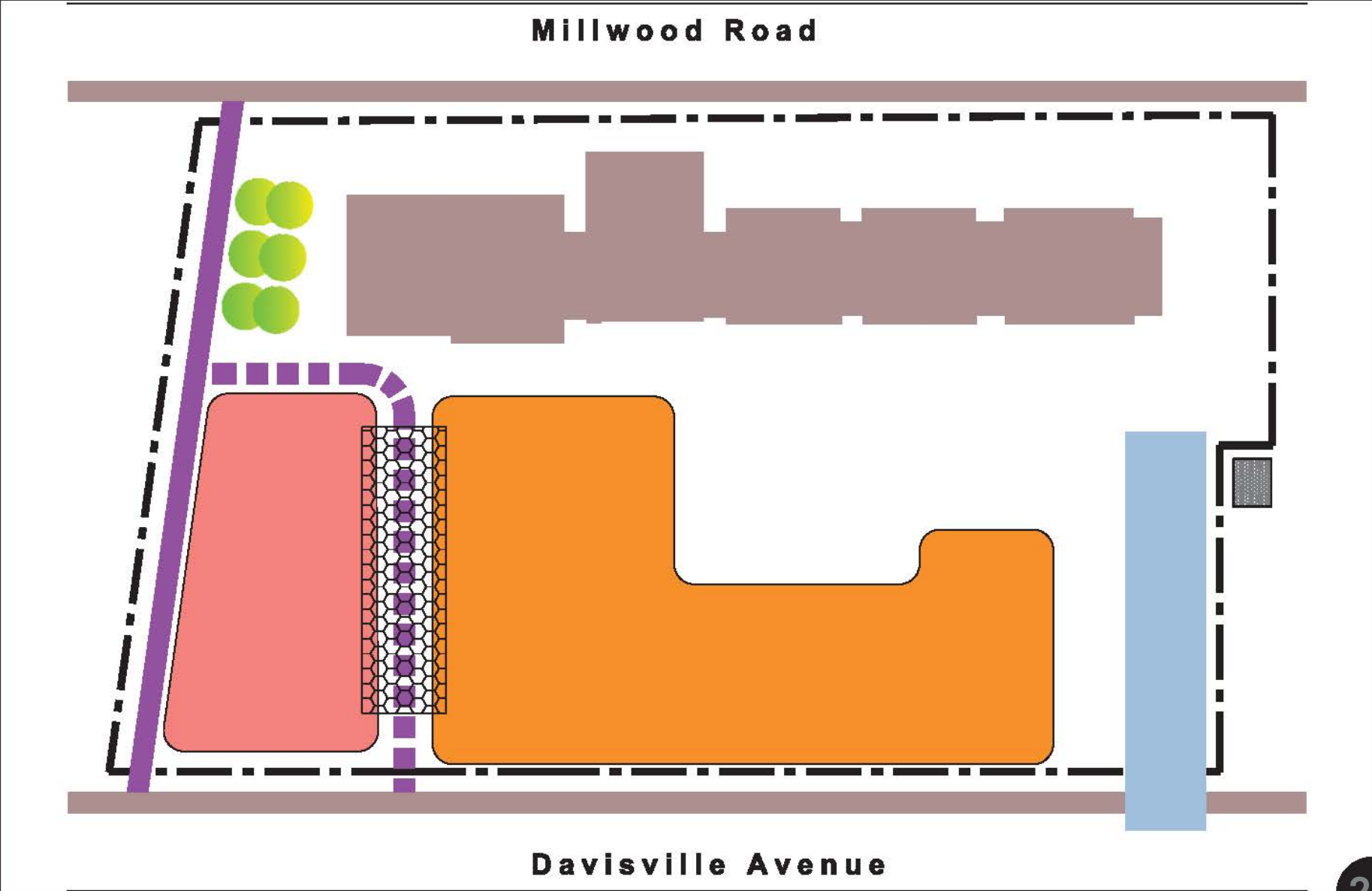

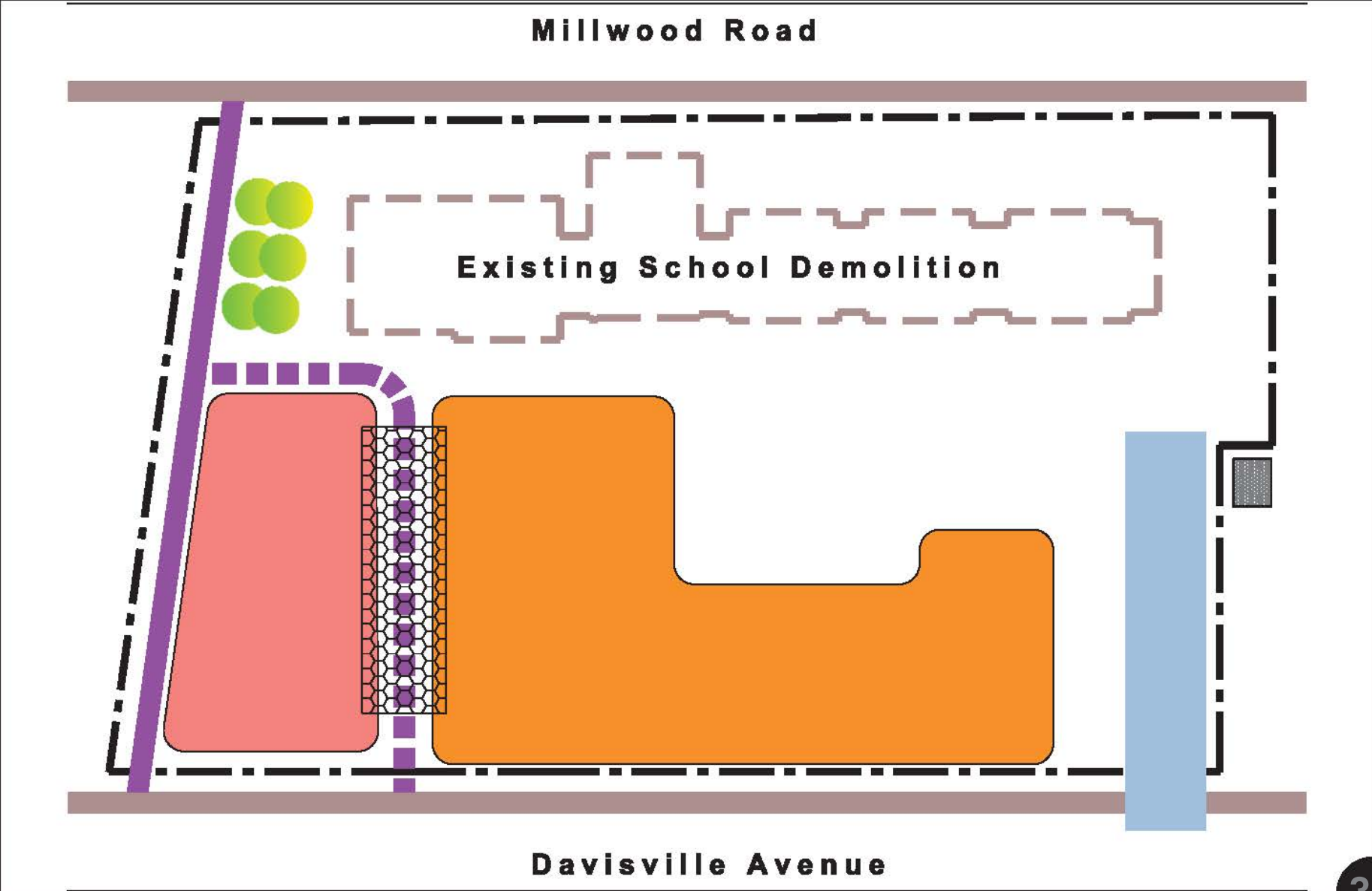

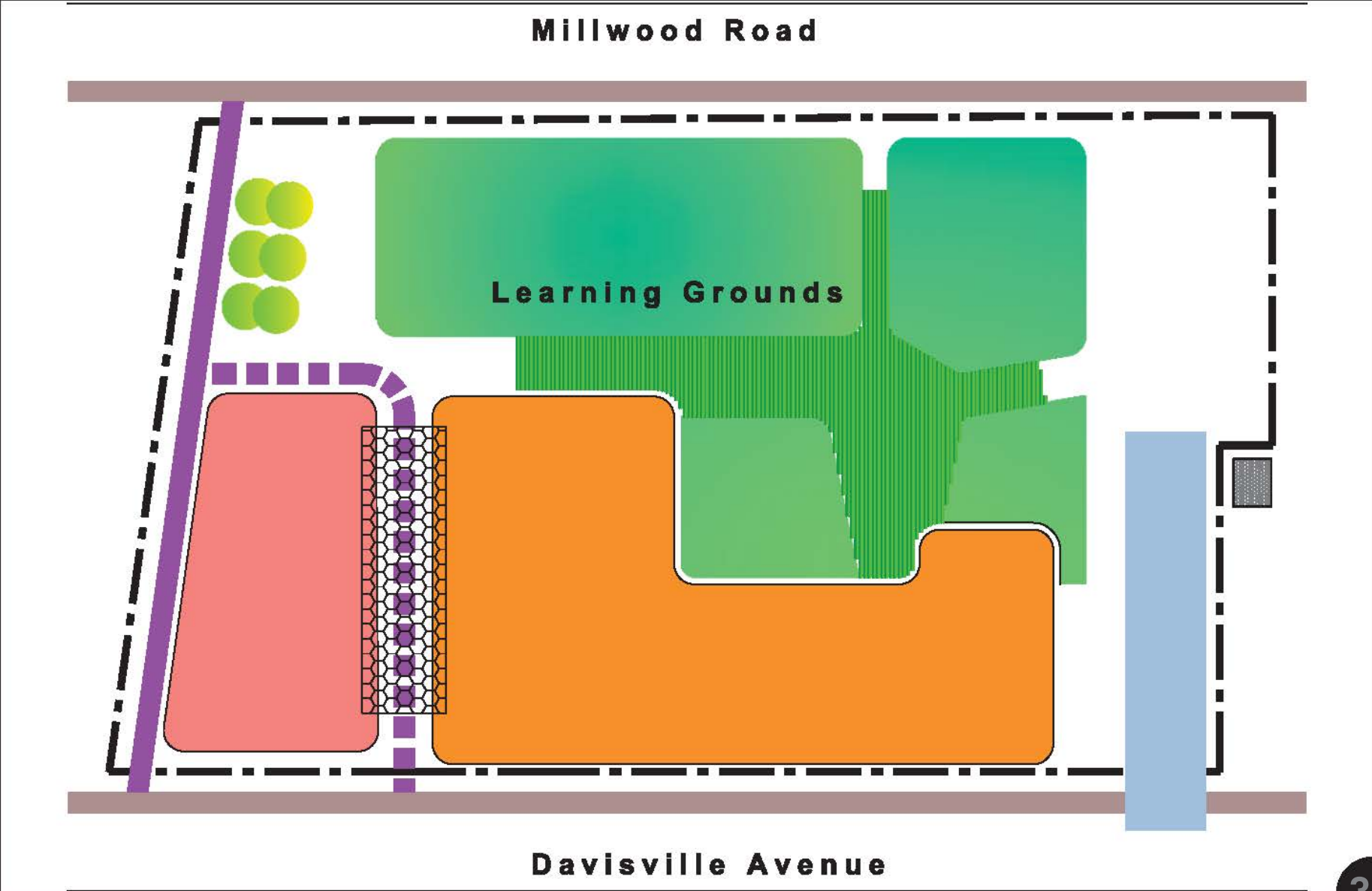

# SITE CONFIGURATION



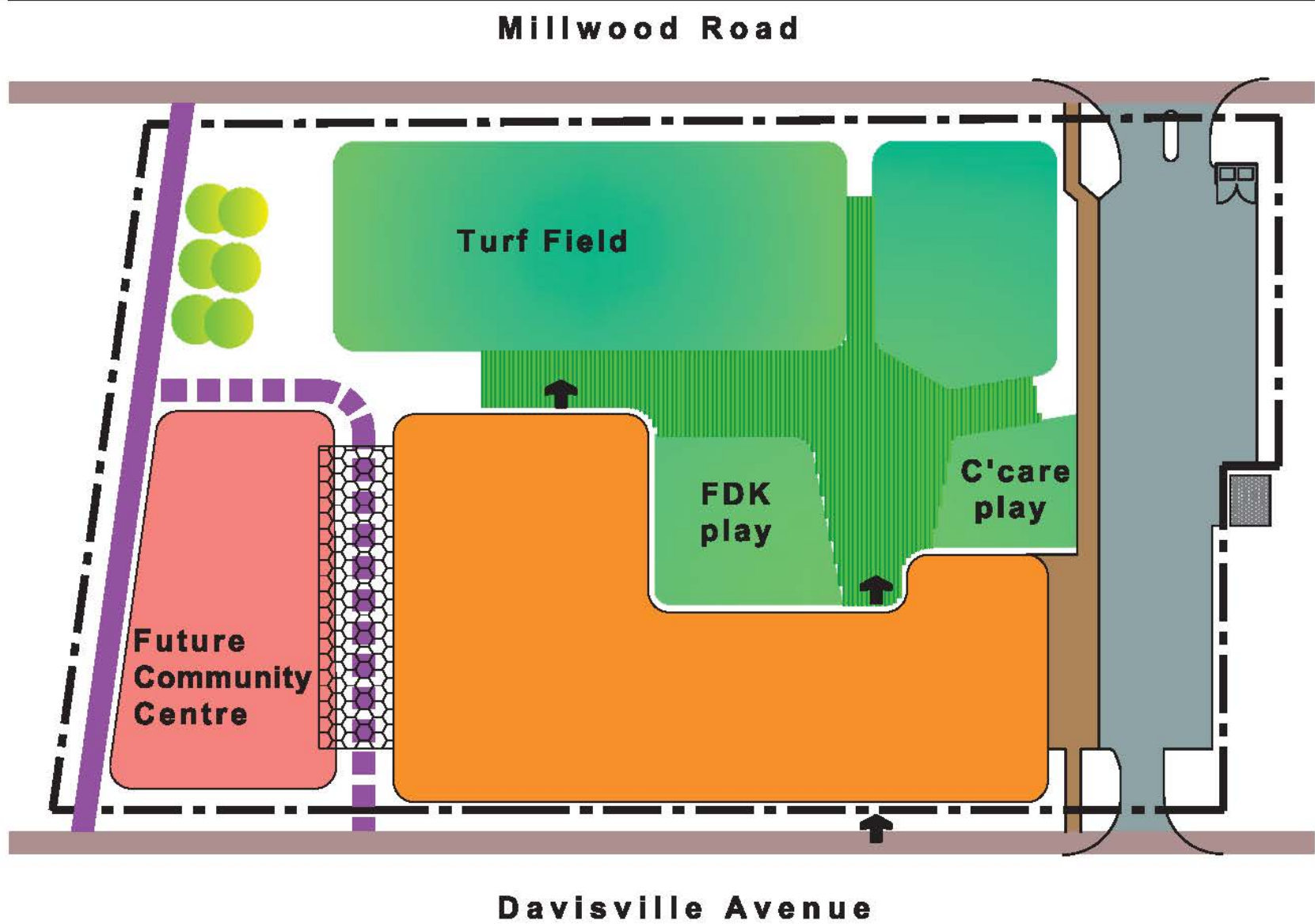

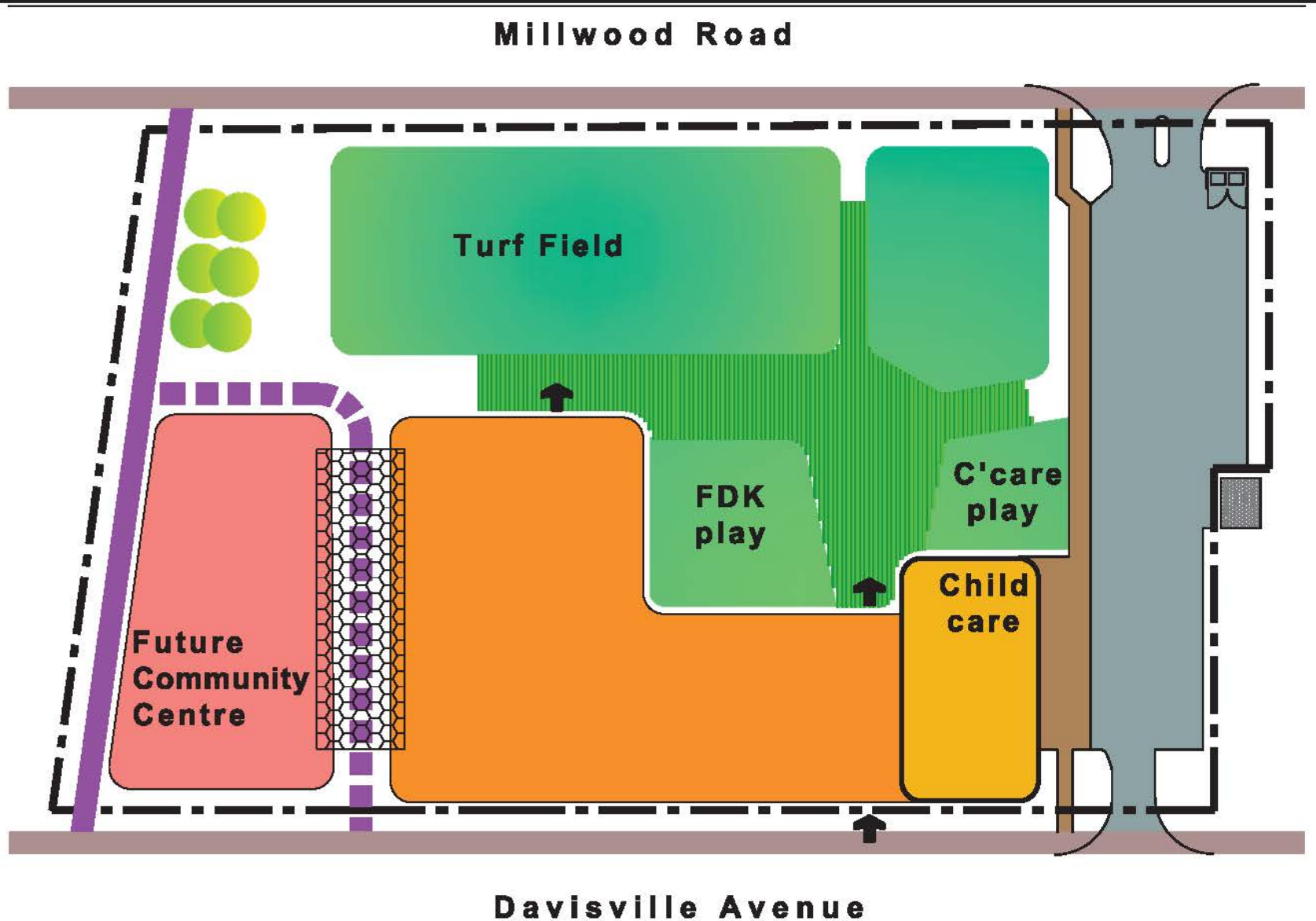

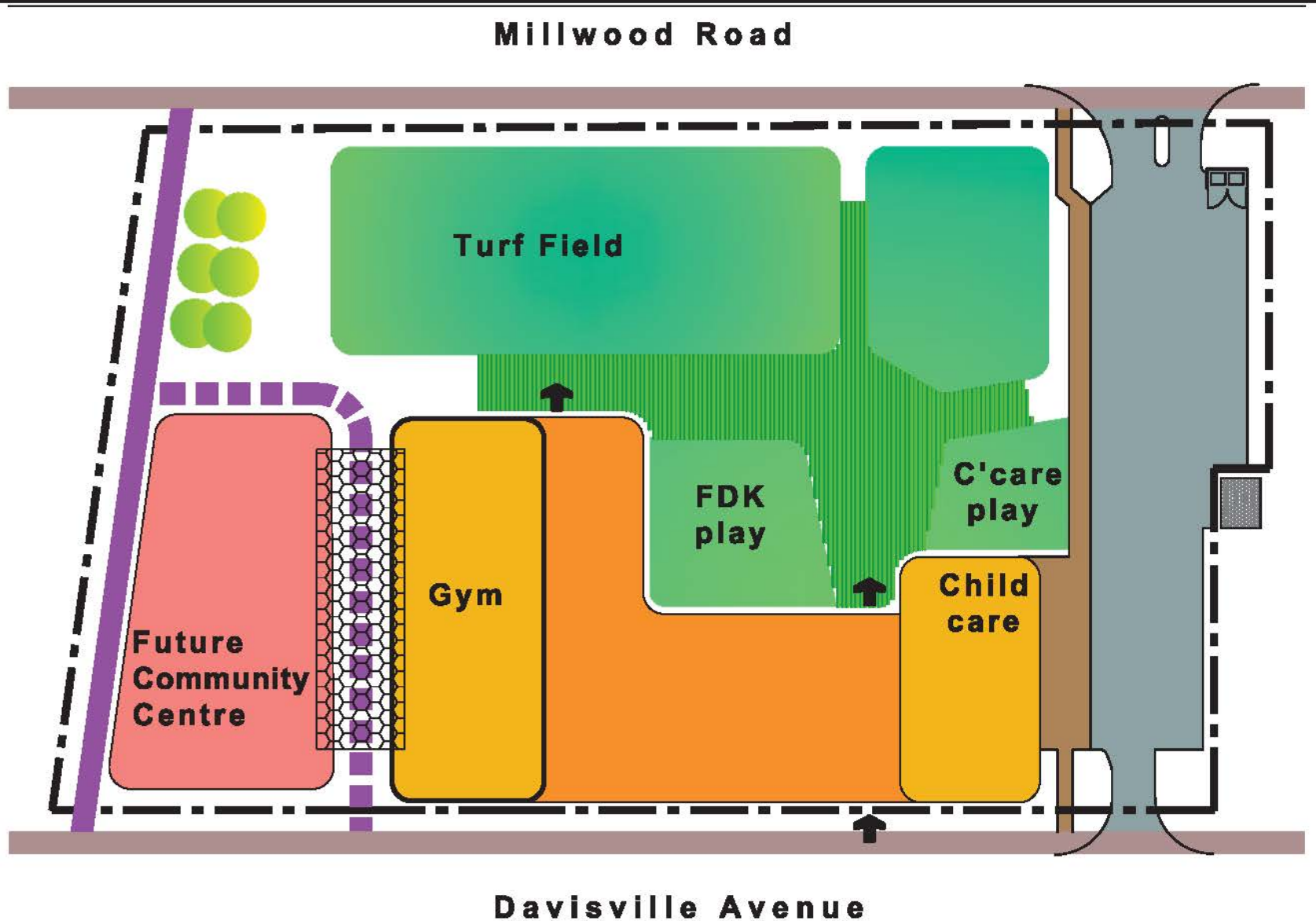

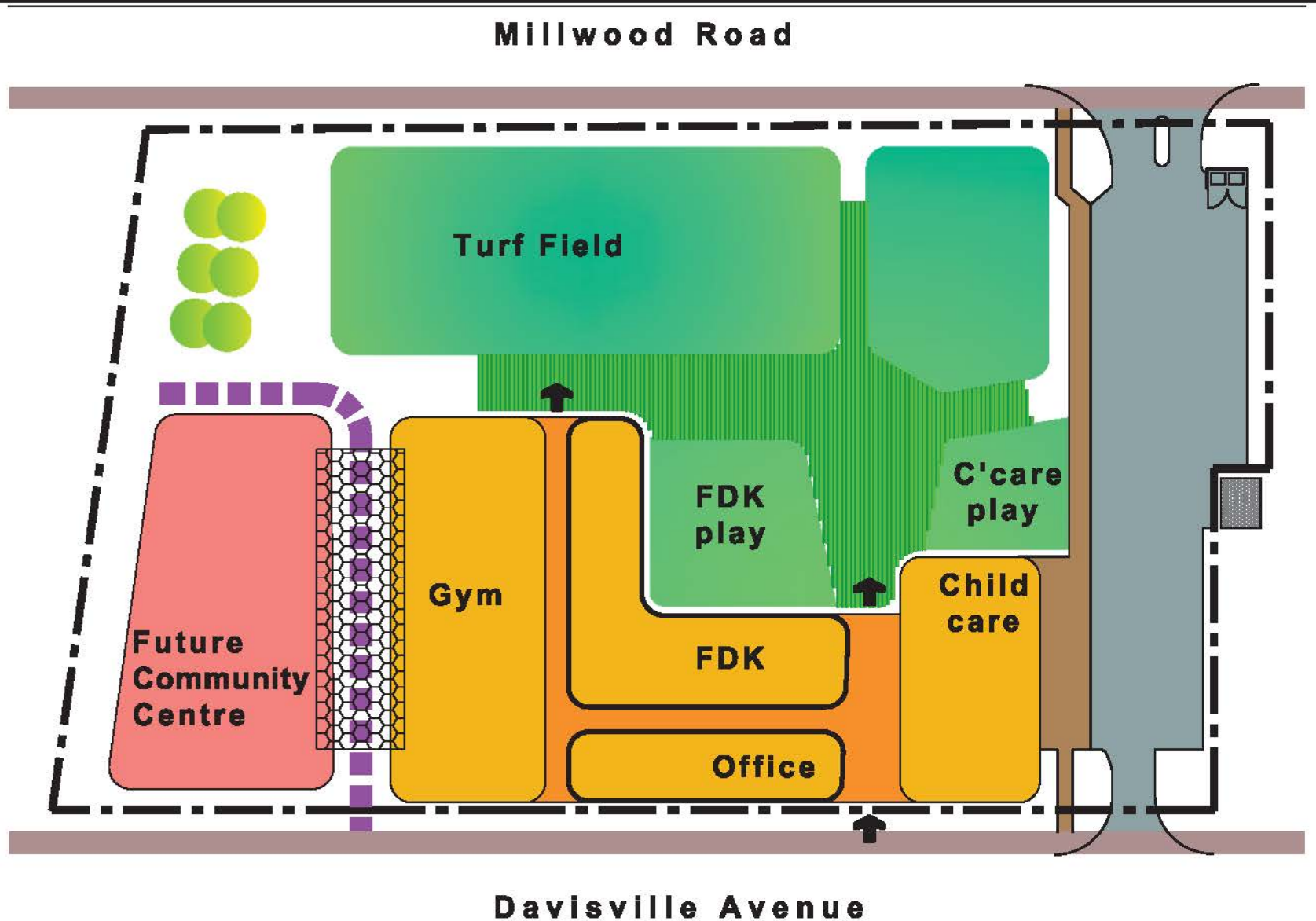

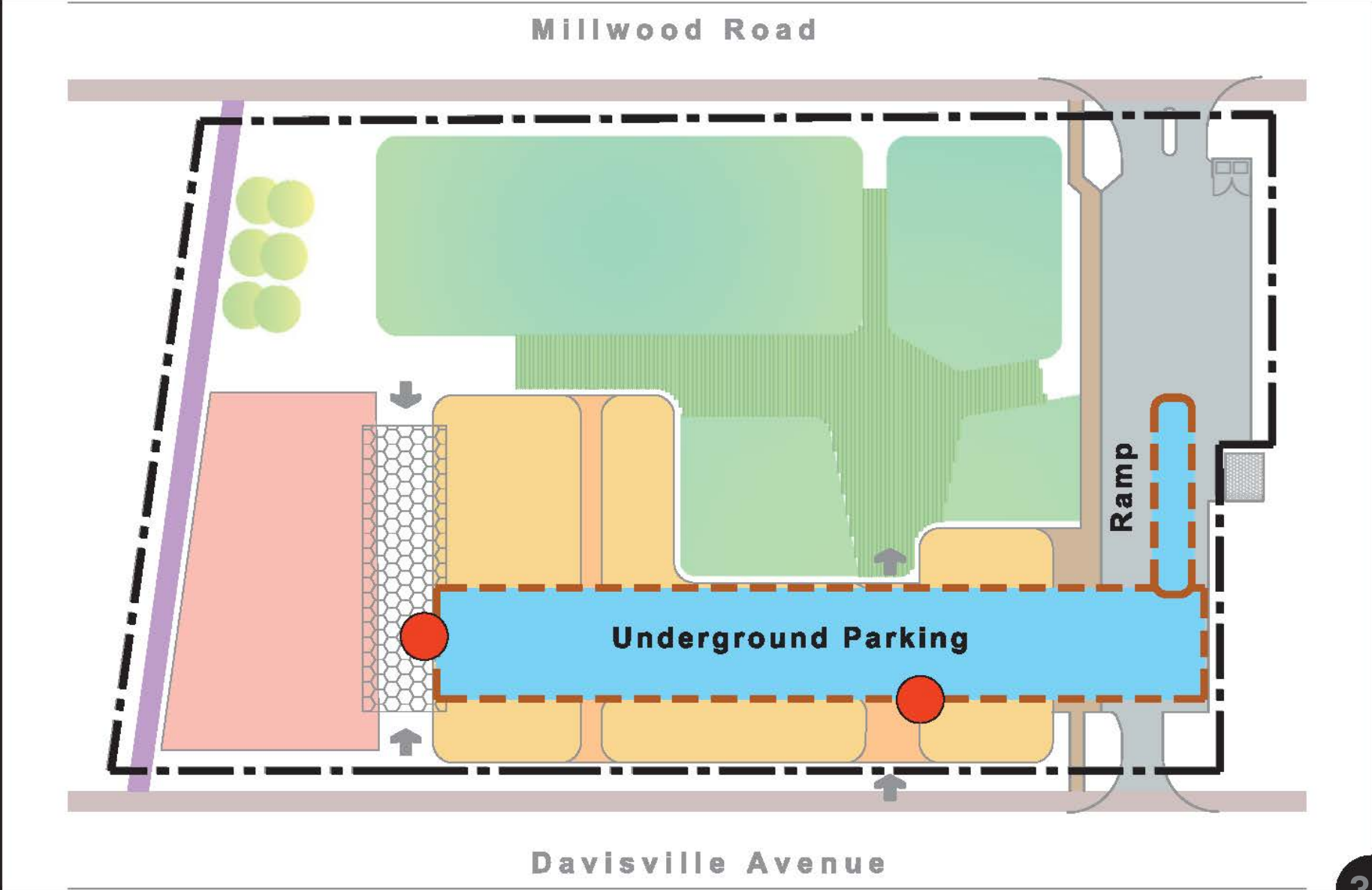

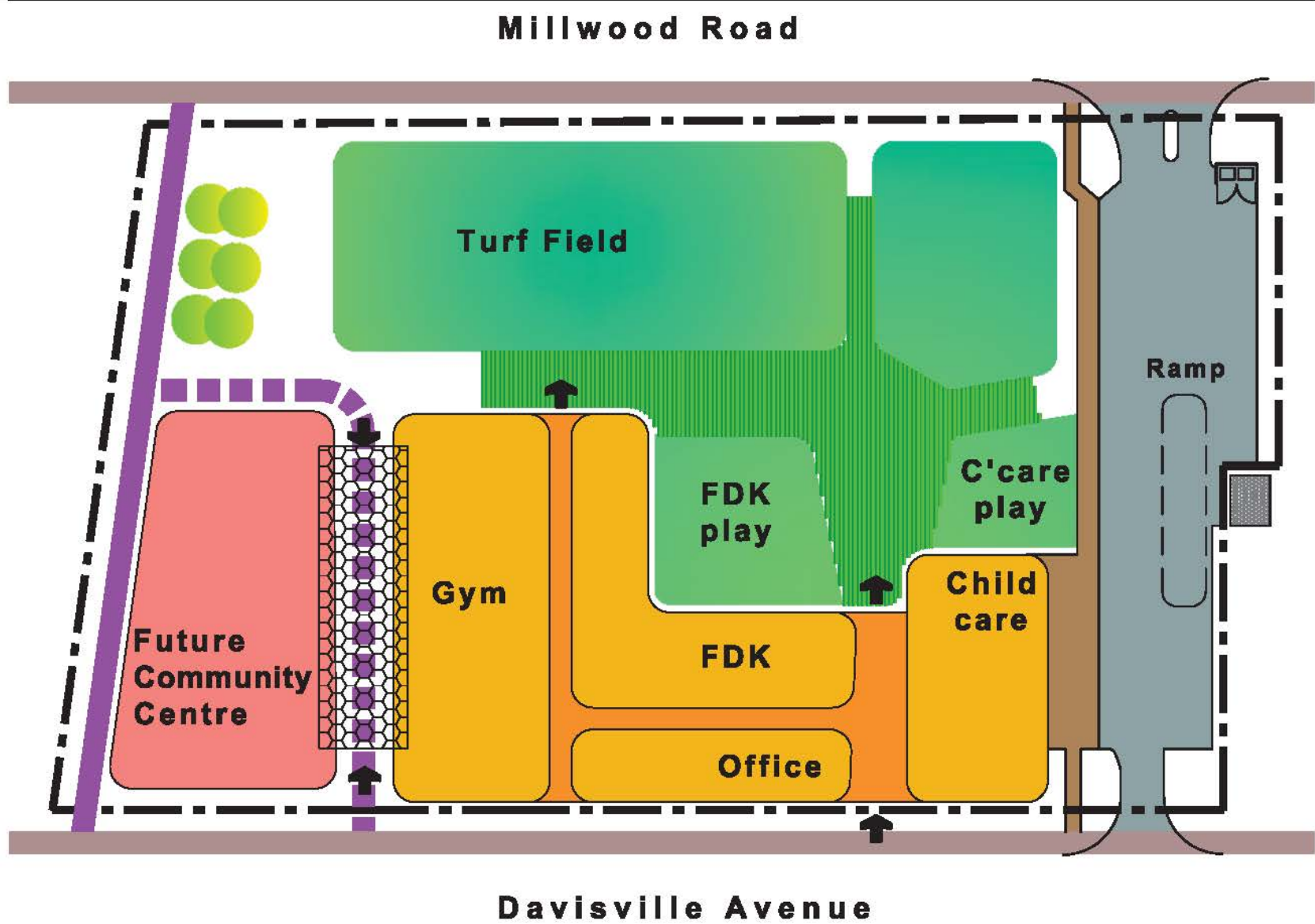

# SITE PHASING

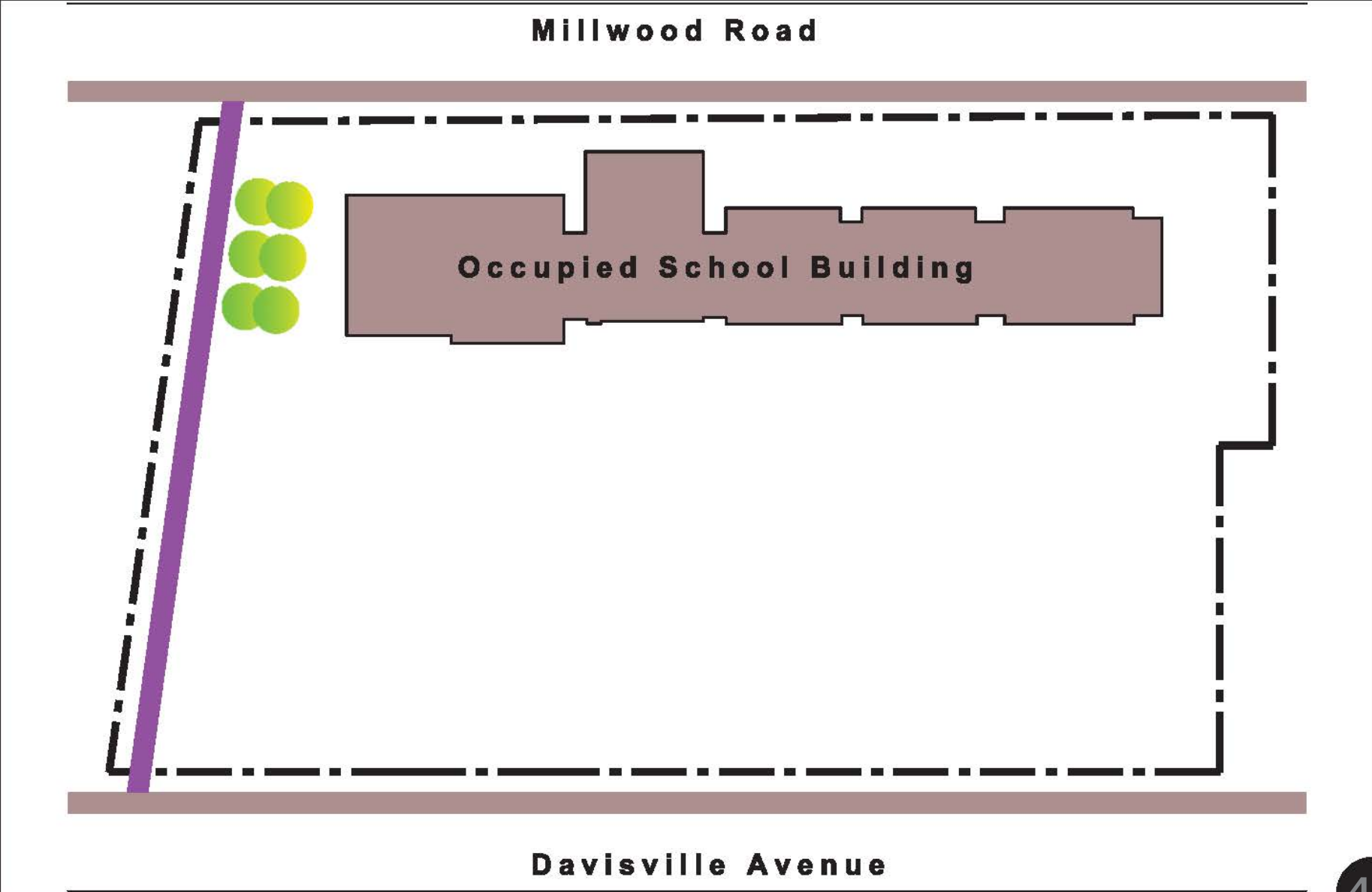



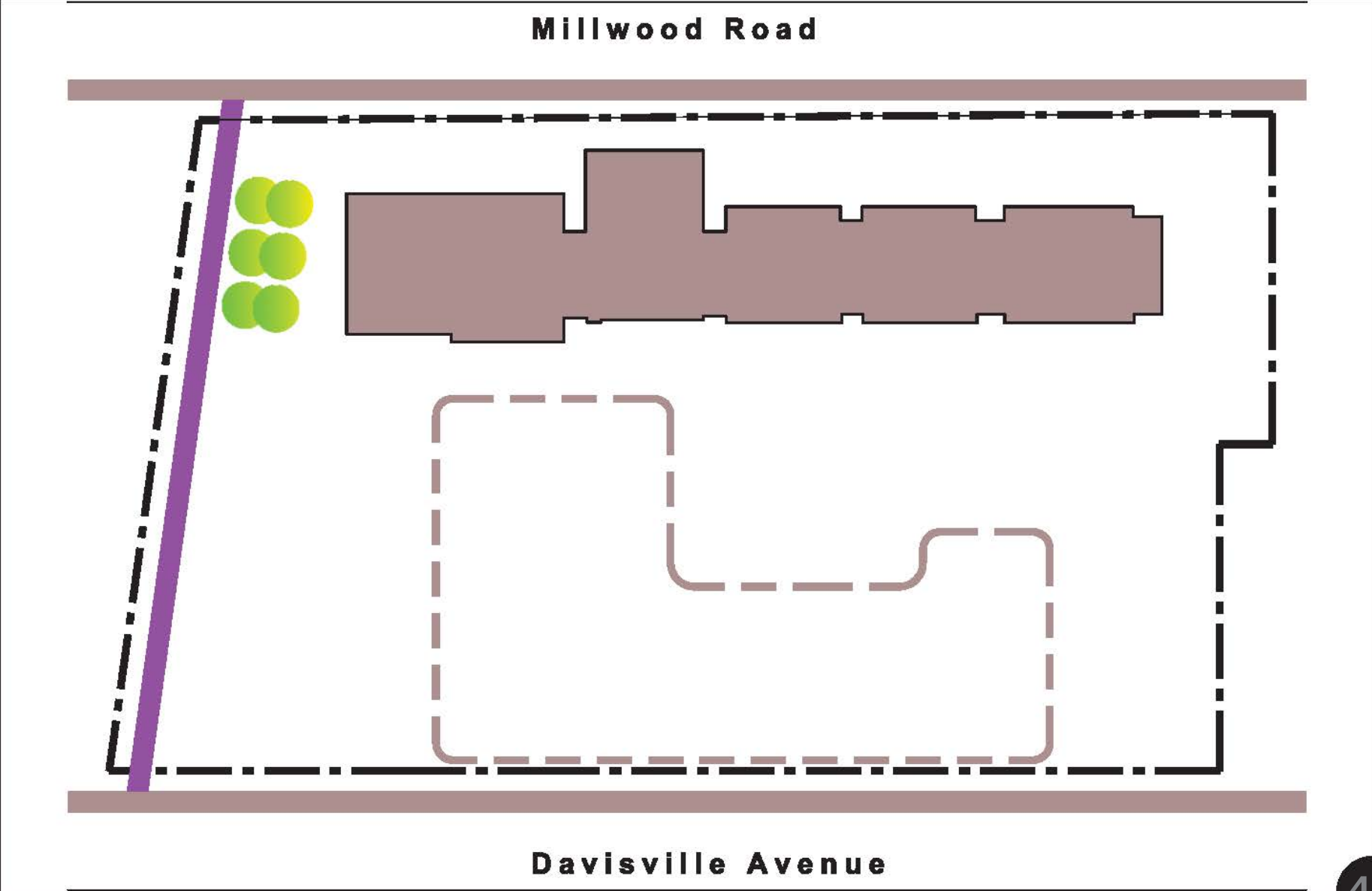

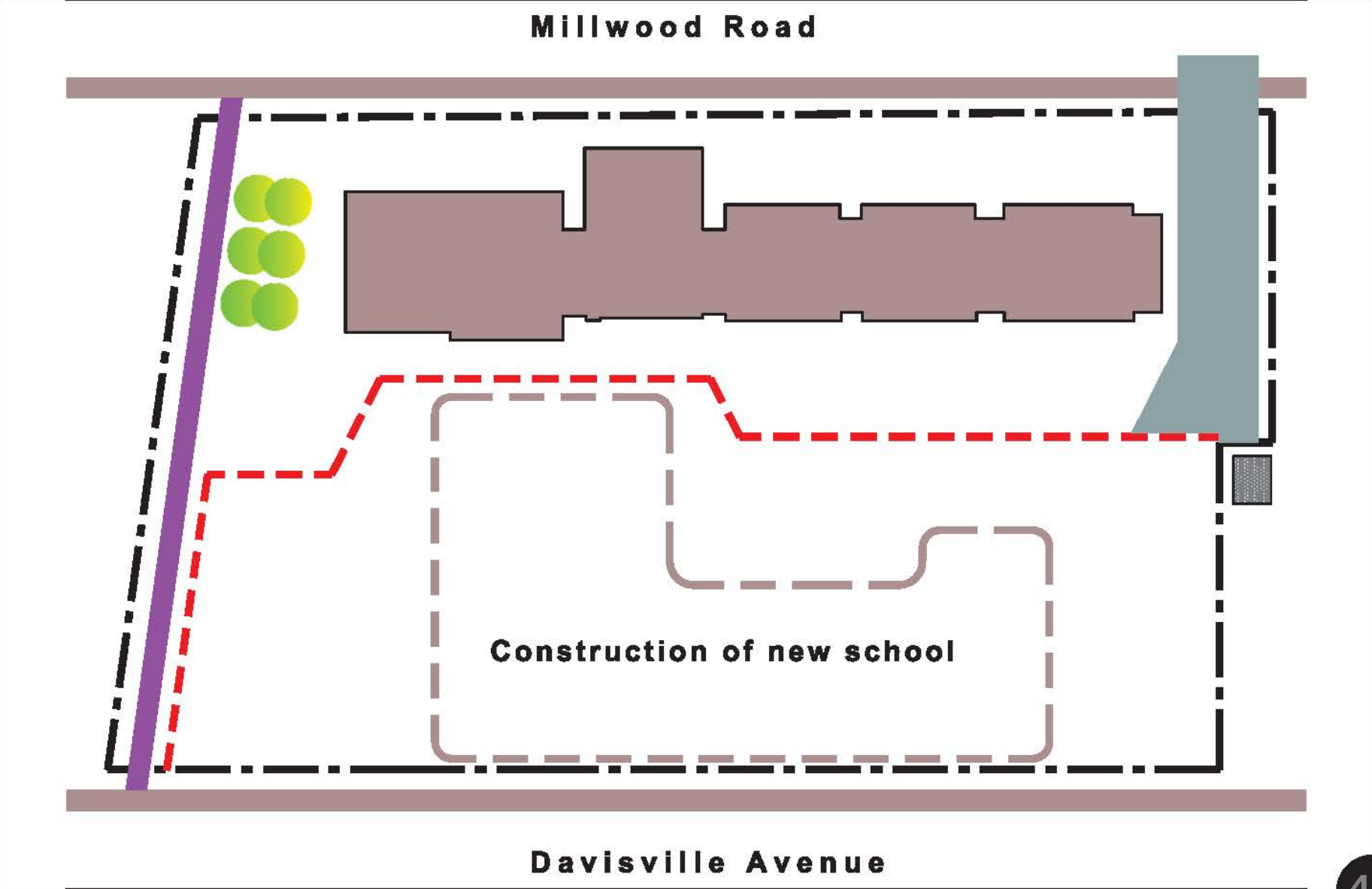

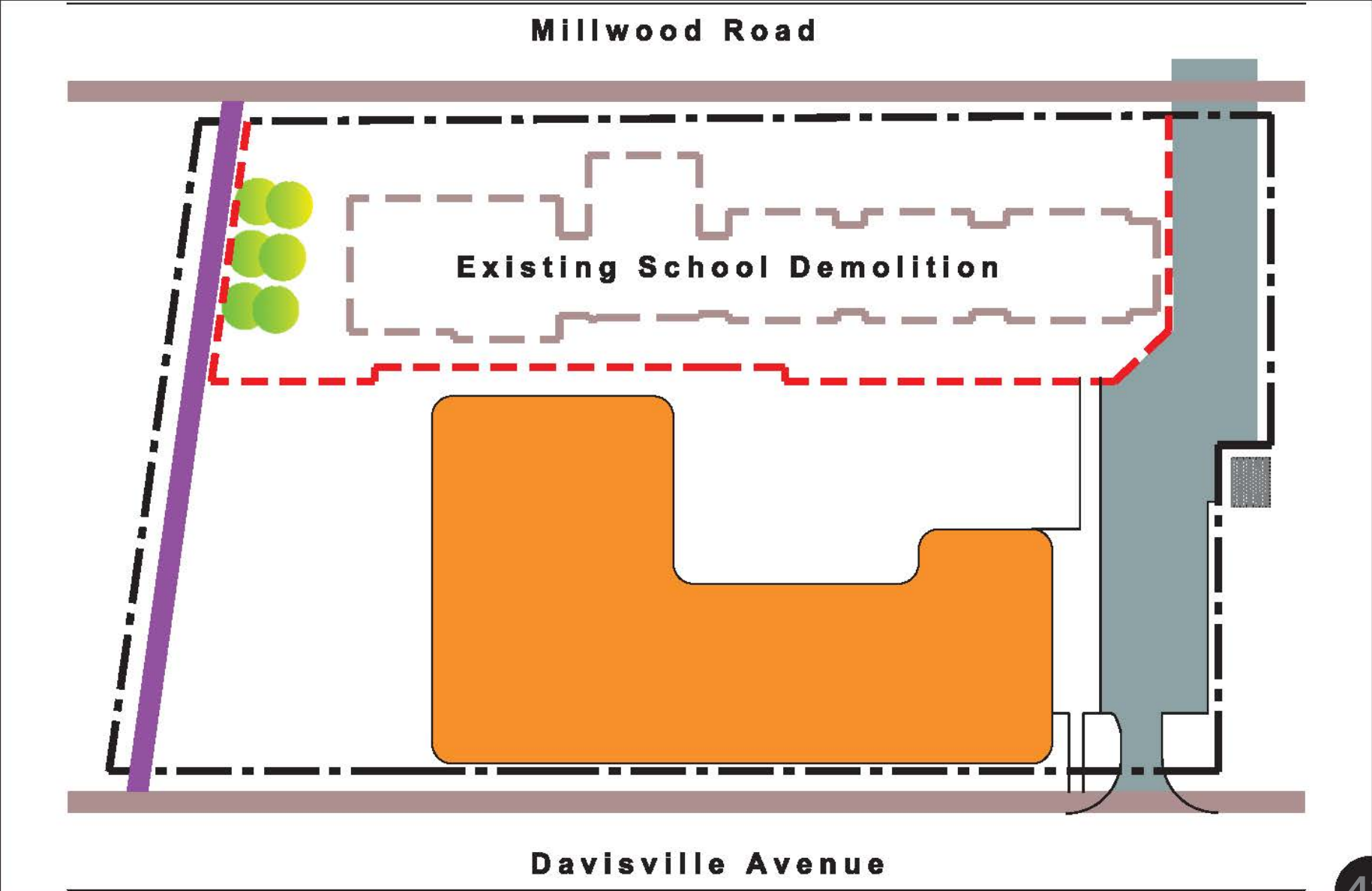

**Millwood Road**

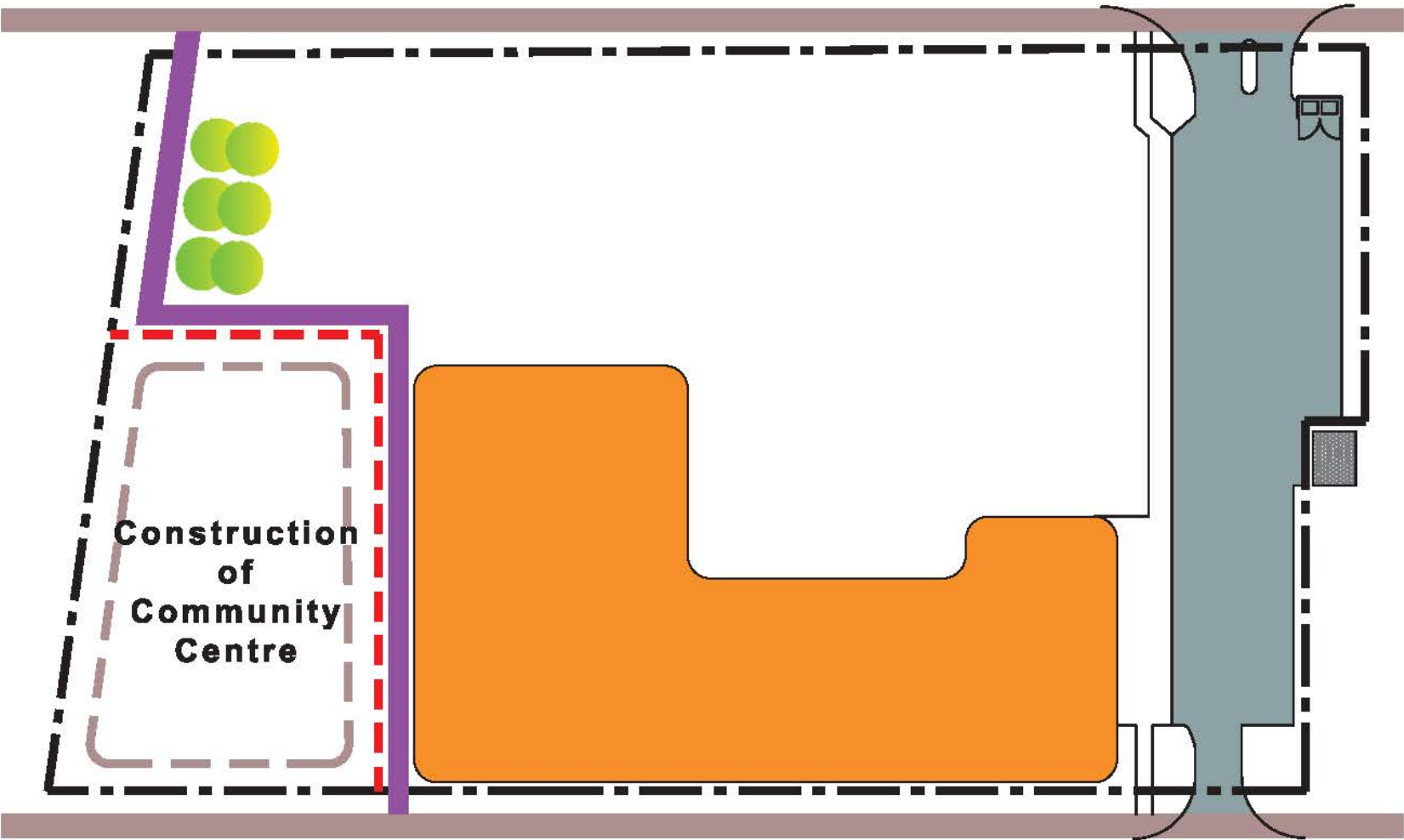

**Construction  
of  
Community  
Centre**

**Davisville Avenue**

## 21st century learner centred school design

